

Submittal Package

viega

Viega® PEX Crimp PolyAlloy™ Fittings

Project:

Engineer:

Contractor:

Submitted By:

Potable Water

Other _____

Submittal Package

viega

Viega® PEX Crimp PolyAlloy™ Fittings

Technical Data

Materials:

| | |
|--------------------------------------|--|
| Fittings..... | PolyAlloy (Acudel® and Radel-R®) |
| Crimp Rings..... | Copper (black) |
| MANABLOC Manifolds..... | Polysulfone (plastic) PolyAlloy fittings |
| PEX Crimp Poly Manifolds..... | PolyAlloy crimp connections |
| Valves..... | PolyAlloy |
| ViegaPEX, ViegaPEX Ultra Tubing..... | PEX (crosslinked polyethylene) |

Applications

Viega PEX Crimp zero lead brass and Polyalloy PEX Crimp fittings are intended for use in potable water systems. They can be directly buried in soil but shall be wrapped (fittings used in concrete shall also be wrapped). Fittings are manufactured with Viega PEX Crimp bars for use with ViegaPEX, ViegaPEX Ultra tubing, crimp rings and tools.

Installation

- Use only ASTM F1807 crimp rings and approved full circle crimp tools to make connections.
- Keep flame and excessive heat away from tubing and connections.
- Refer to the Viega PEX Installation Manual for additional information.

“Zero Lead” identifies Viega® products meeting the lead free requirements of NSF 61-G through testing under NSF/ANSI 372 (0.25% or less maximum weighted average lead content).

Codes Approvals & Standards

ANSI/NSF 61-G
cNSF® us pw-G
CSA B137.5
U.P. Code
UPC®
ASTM F876 / F877
ASTM F1807 / F2159
ICC ES-PMG™ 1038

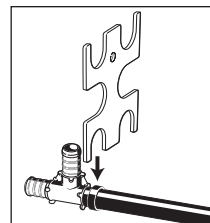
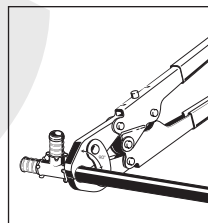
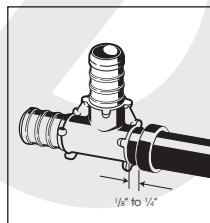

THREE SIMPLE STEPS TO A SECURE VIEGA PEX CRIMP FITTING CONNECTION.

1. SLIDE CRIMP RING OVER END OF SQUARED OFF TUBING, FULLY INSERT FITTING INTO TUBING AND POSITION THE RING 1/8" TO 1/4" FROM THE END OF TUBING.
2. KEEP THE TOOL AT 90° AND CLOSE THE HANDLES COMPLETELY. DO NOT CRIMP TWICE.
3. CHECK CRIMP WITH GO/ NO GO GAUGE.

Submittal Package

viega



Viega® PEX Crimp PolyAlloy™ Fittings

ViegaPEX and ViegaPEX UltraTubing

Material.....PEX crosslinked polyethylene
Temperature/Pressure Ratings...200°F at 80 psi
180°F at 100 psi
73.4°F at 160 psi
Linear Expansion Rate.....1.1"/100'/10°F

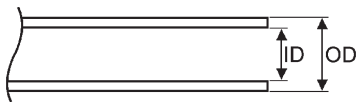

| Nominal Size | Inner Diameter | Outer Diameter | Wall Thickness |
|--------------|----------------|----------------|----------------|
| 3/8" | 0.35 | 0.500±.003 | 0.070±.010 |
| 1/2" | 0.47 | 0.625±.004 | 0.070±.010 |
| 3/4" | 0.67 | 0.875±.004 | 0.097±.010 |
| 1" | 0.86 | 1.125±.005 | 0.125±.013 |

Submittal Package

viega

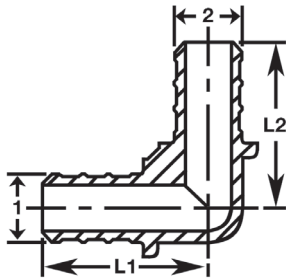

Viega PEX Crimp 90° Elbow Zero Lead PolyAlloy - Model V5216

| Part Number | Size | | L1 (in) | L2 (in) |
|-------------|------|------|---------|---------|
| | 1 | 2 | | |
| 43210 | 3/8" | | 1.15 | 1.15 |
| 43220 | 1/2" | | 1.15 | 1.15 |
| 43240 | 3/4" | | 1.25 | 1.25 |
| 43242 | 3/4" | 1/2" | 1.25 | 1.25 |
| 43260 | 1" | | 1.53 | 1.53 |

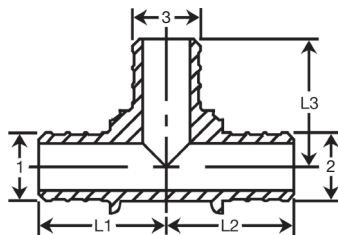

Viega PEX Crimp Tee Zero Lead PolyAlloy - Model V5218

| Part Number | Size | | | L1 (in) | L2 (in) | L3 (in) |
|-------------|------|------|------|---------|---------|---------|
| | 1 | 2 | 3 | | | |
| 43500 | 3/8" | | | 1.16 | 1.16 | 1.16 |
| 43520 | 1/2" | | | 1.15 | 1.15 | 1.15 |
| 43334 | 1/2" | 1/2" | 3/4" | 1.25 | 1.25 | 1.15 |
| 43540 | 3/4" | | | 1.25 | 1.25 | 1.25 |
| 43433 | 3/4" | 1/2" | 1/2" | 1.25 | 1.15 | 1.25 |
| 43434 | 3/4" | 1/2" | 3/4" | 1.25 | 1.25 | 1.25 |
| 43443 | 3/4" | 3/4" | 1/2" | 1.15 | 1.15 | 1.25 |
| 43445 | 3/4" | 3/4" | 1" | 1.30 | 1.30 | 1.34 |
| 43544 | 1" | 3/4" | 3/4" | 1.37 | 1.36 | 1.36 |
| 43545 | 1" | 3/4" | 1" | 1.54 | 1.39 | 1.54 |
| 43553 | 1" | 1" | 1/2" | 1.33 | 1.33 | 1.32 |
| 43554 | 1" | 1" | 3/4" | 1.33 | 1.33 | 1.26 |
| 43560 | 1" | | | 1.53 | 1.53 | 1.53 |

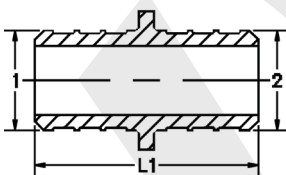

Viega PEX Crimp Coupling Zero Lead PolyAlloy - Model V5215

| Part Number | Size | | L(in) |
|-------------|------|------|-------|
| | 1 | 2 | |
| 43402 | 3/8" | | 1.52 |
| 43403 | 1/2" | | 1.50 |
| 43332 | 1/2" | 3/8" | 1.52 |
| 43343 | 3/4" | 1/2" | 1.50 |
| 43353 | 1" | 1/2" | 1.70 |
| 43404 | 3/4" | | 1.50 |
| 43354 | 1" | 3/4" | 1.70 |
| 43355 | 1" | | 1.82 |

Submittal Package

viega

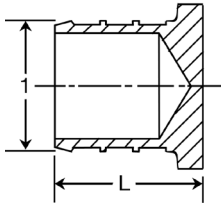

Viega PEX Crimp Test Plug Zero Lead PolyAlloy - Model V5058

| Part Number | Size | L (in) |
|-------------|----------|--------|
| | 1 | |
| 43702 | 3/8" | 0.76 |
| 43723 | 1/2" | 0.76 |
| 43744 | 3/4" | 0.95 |
| 43765 | 1" | 1.13 |

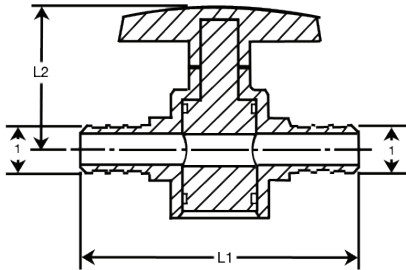

Viega PEX Crimp Valve Zero Lead PolyAlloy 1/4 Turn - Model V5236

| Part Number | Size | L1 (in) | L2 (in) |
|-------------|----------|---------|---------|
| | 1 | | |
| 43030 | 1/2" | 2.83 | 1.45 |
| 43040 | 3/4" | 3.00 | 1.45 |

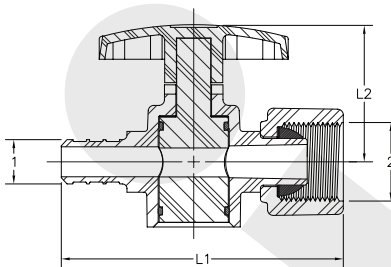

Viega PEX Crimp Stop Valve Straight Zero Lead PolyAlloy Crimp x Lav 1/4 Turn - Model V5036.30

| Part Number | Size | L1 (in) | L2 (in) |
|-------------|-----------------|---------|---------|
| | 1 2 | | |
| 43023 | 3/8" x 1/2" Lav | 3.00 | 1.45 |
| 43031 | 1/2" x 1/2" Lav | 3.00 | 1.45 |

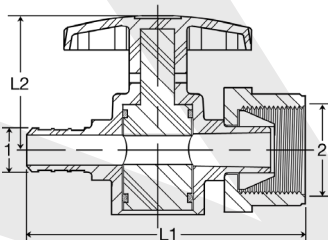

Viega PEX Crimp Stop Valve Straight Zero Lead PolyAlloy Crimp x Closet 1/4 Turn - Model V5036-31

| Part Number | Size | L1 (in) | L2 (in) |
|-------------|--------------------|---------|---------|
| | 1 2 | | |
| 43002 | 3/8" x 1/2" Closet | 3.00 | 1.45 |
| 43003 | 1/2" x 1/2" Closet | 3.00 | 1.45 |

Submittal Package

viega

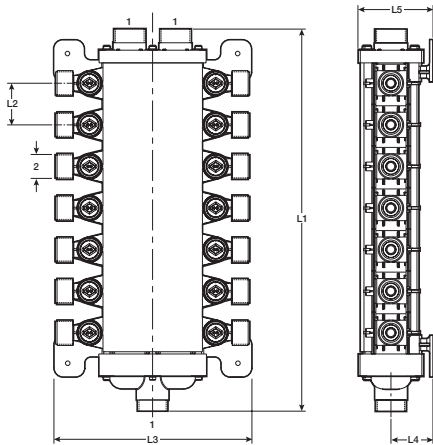

Viega ManaBloc Distribution Manifold Zero Lead Crimp - Model V5030.5

| Part Number | Size | | Ports | L1 | L2 | L3 | L4 | L5 |
|-------------|----------------|----|--------|-------|-------|-------|-------|----|
| | 1 | 2 | | | | | | |
| 50143 | 1" x 5/8" NPSM | 14 | 15.44" | 1.68" | 8.00" | 1.70" | 3.00" | |
| 51618 | 1" x 5/8" NPSM | 18 | 18.80" | 1.68" | 8.00" | 1.70" | 3.00" | |
| 50243 | 1" x 5/8" NPSM | 24 | 23.78" | 1.68" | 8.00" | 1.70" | 3.00" | |
| 50303 | 1" x 5/8" NPSM | 30 | 28.88" | 1.68" | 8.00" | 1.70" | 3.00" | |
| 50363 | 1" x 5/8" NPSM | 36 | 33.92" | 1.68" | 8.00" | 1.70" | 3.00" | |

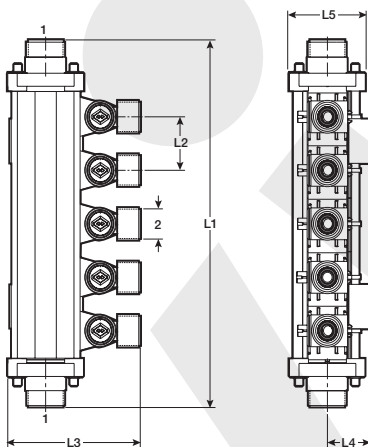

Viega MiniBloc Zoning Manifold Zero Lead Crimp - Model V5031.5

| Part Number | Size | | Ports | L1 | L2 | L3 | L4 | L5 |
|-------------|----------------|----|--------|-------|-------|-------|-------|----|
| | 1 | 2 | | | | | | |
| 50033 | 1" x 5/8" NPSM | 3 | 8.19" | 1.68" | 4.37" | 1.42" | 2.50" | |
| 50043 | 1" x 5/8" NPSM | 4 | 9.87" | 1.68" | 4.37" | 1.42" | 2.50" | |
| 51063* | 1" x 5/8" NPSM | 5 | 11.55" | 1.68" | 4.37" | 1.42" | 2.50" | |
| 50063 | 1" x 5/8" NPSM | 6 | 13.23" | 1.68" | 4.37" | 1.42" | 2.50" | |
| 51073* | 1" x 5/8" NPSM | 7 | 14.91" | 1.68" | 4.37" | 1.42" | 2.50" | |
| 50083 | 1" x 5/8" NPSM | 8 | 16.59" | 1.68" | 4.37" | 1.42" | 2.50" | |
| 51003* | 1" x 5/8" NPSM | 10 | 19.95" | 1.68" | 4.37" | 1.42" | 2.50" | |

*Manifold incorporates hot and cold ports.

Submittal Package

viega

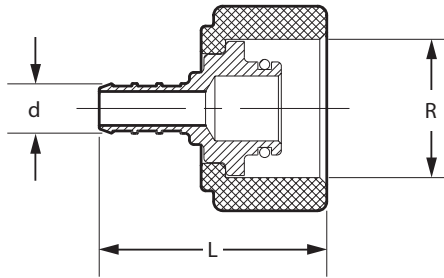

Viega PEX Crimp Port Adapter Zero Lead PolyAlloy for ManaBloc Crimp x Port - Model V5039.1

| Part Number | Size | | L (in) |
|-------------|------------------|---|--------|
| | 1 | 2 | |
| 50023 | 3/8" x 1/2" Port | | 1.58 |
| 50133 | 1/2" x 1/2" Port | | 1.58 |

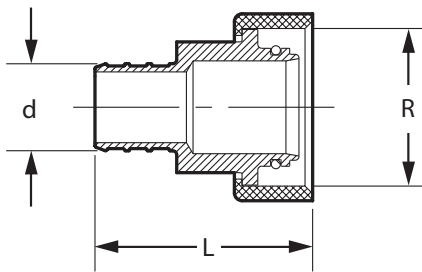

Viega PEX Crimp Supply Adapter Zero Lead PolyAlloy for ManaBloc Crimp x Supply - Model V5213

| Part Number | Size | | L (in) |
|-------------|--------------------|---|--------|
| | 1 | 2 | |
| 50141 | 3/4" x 1" ManaBloc | | 1.66 |
| 50151 | 1" x 1" ManaBloc | | 1.84 |

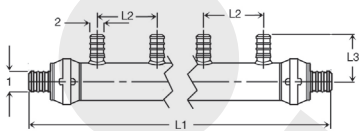

Viega PEX Crimp Manifold Zero Lead PolyAlloy Flow Through - Model V5031.2

| Part Number | Size | | L1 (in) | L2 (in) | L3 (in) |
|-------------|-----------------------------|---|---------|---------|---------|
| | 1 | 2 | | | |
| 65152 | 3/4" x 1/2" - 2 Outlet | | 6.50 | 2.00 | 1.55 |
| 65153 | 3/4" x 1/2" - 3 Outlet | | 8.50 | 2.00 | 1.55 |
| 65154 | 3/4" x 1/2" - 4 Outlet | | 10.50 | 2.00 | 1.55 |
| 65254 | 1" x 3/4" x 1/2" - 4 Outlet | | 10.60 | 2.00 | 1.55 |
| 65256 | 1" x 1/2" - 6 Outlet | | 14.80 | 2.00 | 1.55 |
| 65258 | 1" x 1/2" - 8 Outlet | | 18.80 | 2.00 | 1.55 |

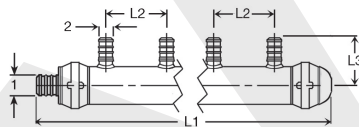

Viega PEX Crimp Manifold Zero Lead PolyAlloy Closed - Model V5031.22

| Part Number | Size | | L1 (in) | L2 (in) | L3 (in) |
|-------------|------------------------|---|---------|---------|---------|
| | 1 | 2 | | | |
| 65104 | 3/4" x 1/2" - 4 Outlet | | 10.10 | 2.00 | 1.55 |
| 65206 | 1" x 1/2" - 6 Outlet | | 14.30 | 2.00 | 1.55 |

Submittal Package

viega

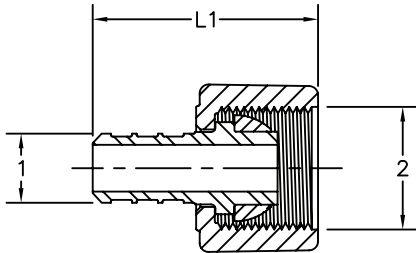

Viega PEX Crimp Lav Adapter Zero Lead PolyAlloy Crimp x Lav - Model V5263

| Part Number | Size | | L1 (in) |
|-------------|------|----------|---------|
| | 1 | 2 | |
| 43323 | 3/8" | 1/2" Lav | 1.52 |
| 43333 | 1/2" | 1/2" Lav | 1.46 |
| 43344 | 3/4" | 3/4" Lav | 1.62 |

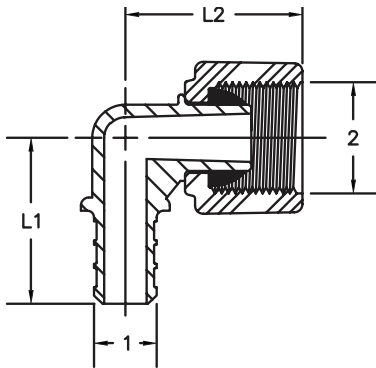

Viega PEX Crimp Lav Adapter 90° Elbow Zero Lead PolyAlloy Crimp x Lav - Model V5255

| Part Number | Size | | L1 (in) | L2 (in) |
|-------------|------|----------|---------|---------|
| | 1 | 2 | | |
| 43232 | 3/8" | 1/2" Lav | 1.35 | 1.15 |
| 43233 | 1/2" | 1/2" Lav | 1.35 | 1.15 |
| 43244 | 3/4" | 3/4" Lav | 1.42 | 1.25 |

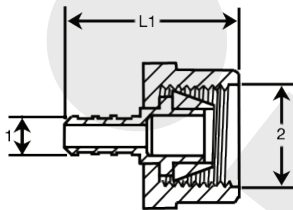

Viega PEX Crimp Closet Adapter Zero Lead PolyAlloy Crimp x Closet - Model V5257

| Part Number | Size | | L1 (in) |
|-------------|------|-------------|---------|
| | 1 | 2 | |
| 43300 | 3/8" | 1/2" Closet | 1.60 |
| 43320 | 1/2" | 1/2" Closet | 1.60 |

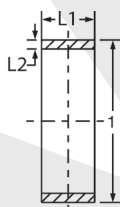

Viega PEX Crimp Ring Copper - Model V5019.9

| Part Number | Size | L1 (in) | L2 (in) |
|-------------|-----------|---------|---------|
| | | | |
| 43600 | 3/8" SDR9 | 0.32 | 0.05 |
| 43620 | 1/2" SDR9 | 0.32 | 0.05 |
| 43640 | 3/4" SDR9 | 0.32 | 0.05 |
| 43660 | 1" SDR9 | 0.36 | 0.04 |

This document subject to updates. For the most current Viega technical literature please visit www.viega.us.
Click Services -> Click Electronic Literature Downloads -> Select Product Line -> Select Desired Document

Viega LLC, 100 N. Broadway, 6th Floor • Wichita, KS 67202 • Ph: 800-976-9819 • Fax: 316-425-7618