

BALCONY AND TERRACE PROFILES

INNOVATIVE SOLUTIONS FOR CERAMIC AND STONE TILE

FINISHING, EDGE PROTECTION, AND GUTTER SYSTEM

Ceramic and stone tiles are ideal surface coverings for the exterior and have been used successfully in outdoor applications for thousands of years. Exterior balconies and terraces provide excellent opportunities for the installation of tiled surfaces. The Schluter®-BARA/-BARIN products provide edge finishing and a gutter system for water management at balcony and terrace perimeters.

Application and Function

Edge-finishing Profiles

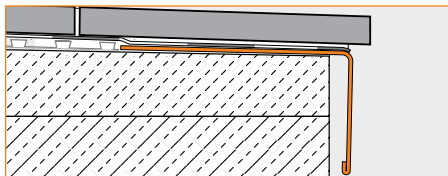

5.3 Schluter®-BARA-RW is a stainless steel or color-coated aluminum, L-shaped edging profile for balconies and terraces. The profile provides a neat edge appearance while concealing and protecting the exposed edges of the setting bed against weathering and corrosion.

Schluter®-BARA-RW is suitable for the renovation of balconies and terraces where a tile covering is to be installed onto an existing substrate using the thin-bed method. The profile is solidly embedded into the thin-set mortar and integrated into the bonded waterproof layer.

Schluter®-BARA-RW is available with a special radius perforation "R" so that the profile can be used to form curves. Matching outside corners and connector pieces are available.

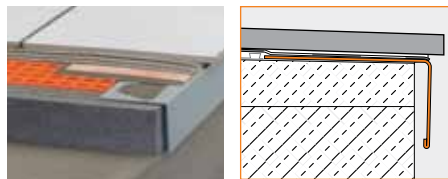

5.3 Schluter®-BARA-RW

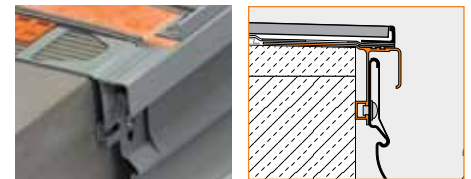

5.9 Schluter®-BARA-RTK

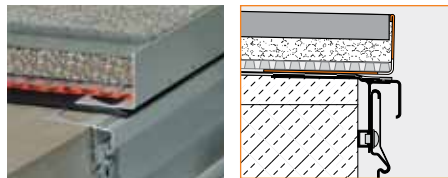

5.15 Schluter®-BARA-RWL

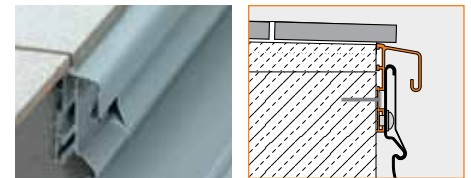

5.11 Schluter®-BARA-RTP

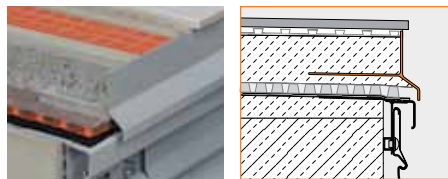

5.4 Schluter®-BARA-RK

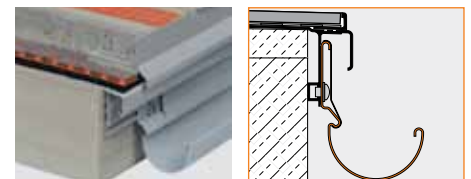

10.1 Schluter®-BARIN

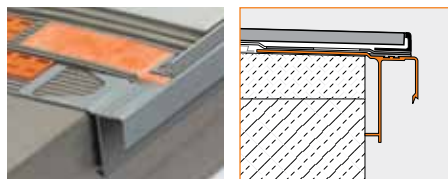

5.5 Schluter®-BARA-RAK

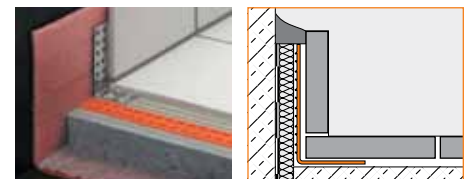

5.1 Schluter®-BARA-ESOT

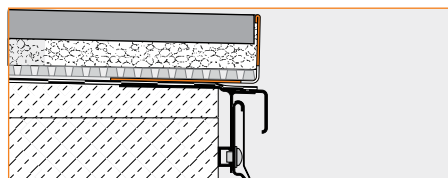

5.15 Schluter®-BARA-RWL is a color-coated aluminum, L-shaped finishing profile for large-format pavers that are laid on loose gravel layers or stilted assemblies above a waterproofing layer and drainage layer.

The trapezoid-perforated anchoring leg of Schluter®-BARA-RWL is placed along the edge, on top of the waterproofing layer, and adjusted to the proper height and alignment. The vertical finishing leg covers the edge of either the entire surface assembly or just the gravel layer or stilts. Profile heights from 9/16" to 5-29/32" (15 to 150 mm) allow for any type of edge formation. Drainage holes, spaced at approximately 2-15/16" (75 mm), are incorporated at the transition of the



anchoring leg and the finishing leg to ensure the proper drainage of any collecting seepage water.

Schluter®-BARA-RWL is available with a special radius perforation "R" so that the profile can be used to form curves.

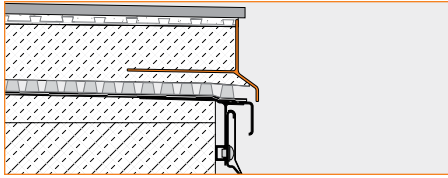

5.4 Schluter®-BARA-RK is a T-shaped edging profile for balconies and terraces. The profile provides a neat edge appearance while concealing and protecting the exposed edges of the mortar bed against weathering and corrosion. The sloped projecting drip edge covers the exposed edges of the Schluter®-TROBA sub-surface drainage system, which is installed below the mortar bed.

During the application of the mortar bed, the trapezoid-perforated anchoring leg of Schluter®-BARA-RK is solidly embedded in the mortar bed while the upper edge of the profile is used to screed the mortar bed to the appropriate height. Install Schluter®-TROBA or Schluter®-TROBA-PLUS for sub-surface drainage between the waterproofing layer and the mortar bed in order to prevent penetrating water from collecting in the mortar bed. If Schluter®-DITRA is to be installed, the screed is leveled 1/8" (3 mm) below the top of the profile. If Schluter®-DITRA-XL is to be installed, the screed is leveled 5/16" (7 mm) below the top of the profile. DITRA and DITRA-XL uncouple the tile covering from the screed and neutralize stresses caused by differential movement between the screed and the tile, primarily due to temperature fluctuations. In addition, DITRA and DITRA-XL, in conjunction with the tile covering, create a bonded waterproof layer. Matching inside corners, outside corners, and connector pieces are available for Schluter®-BARA-RK.

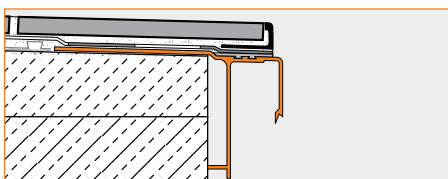

5.5 Schluter®-BARA-RAK is a color-coated aluminum edging profile with a drip lip that finishes the exposed edges of floor

assemblies on balconies and terraces that have an existing sloped screed. Schluter®-BARA-RAK produces a clean edge finish and protects the exposed edges against weathering and decay.

The trapezoid-perforated anchoring leg of Schluter®-BARA-RAK should be integrated with a suitable waterproofing membrane. Once the anchoring leg of Schluter®-BARA-RAK becomes integrated with the waterproofing membrane, tile installation can begin. Schluter®-SCHIENE or Schluter®-RONDEC can be applied to edge the tiles at the recessed transition to the drip lip. The tiles can also be laid with an overhang.

Note: When using Schluter®-BARA-RAK as an edging profile for floor assemblies that are to receive a waterproofing membrane with a mortar screed on top, a drainage layer, such as Schluter®-TROBA or Schluter®-TROBA-PLUS, must be incorporated into the surface assembly.

Matching inside corners, outside corners, and connector pieces are available for Schluter®-BARA-RAK.

**Edge-finishing/
Gutter Support Profiles**

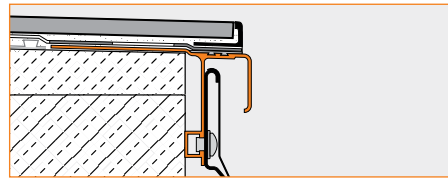

5.9 Schluter®-BARA-RTK is a color-coated aluminum edging and finishing profile for the exposed edges of floor assemblies on balconies and terraces that have an existing sloped substrate. A T-shaped chamber in the vertical leg of Schluter®-BARA-RTK is provided for attaching the Schluter®-BARIN gutter system. Schluter®-BARIN is fastened to the balcony edging profile with screws. The screw slots in the gutter are elongated, making it possible to slope the gutter up to 1-3/16" (30 mm).

The trapezoid-perforated anchoring leg of Schluter®-BARA-RTK should be integrated with a bonded sheet-applied or trowel-applied waterproofing membrane. Once the anchoring leg of Schluter®-BARA-RTK becomes integrated with a suitable water-proofing membrane, the tiles can be bonded directly to the waterproofing layer by observing the manufacturer's specifications. Schluter®-SCHIENE or

Schluter®-RONDEC can be applied to edge the tiles at the recessed transition to the drip lip. The tiles can also be laid with an overhang.

Note: When using Schluter®-BARA-RTK as an edging profile for floor assemblies that are to receive a waterproofing membrane with a mortar screed on top, a drainage layer, such as Schluter®-TROBA or Schluter®-TROBA-PLUS, must be incorporated into the surface assembly.

Matching inside corners, outside corners, and connector pieces are available for Schluter®-BARA-RTK.

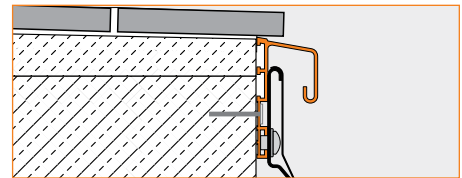

5.11 Schluter®-BARA-RTP is a color-coated aluminum edging profile that can be retrofitted to the exposed edges of existing balconies and terraces. A T-shaped chamber in the vertical leg of Schluter®-BARA-RTP is designed to accept the Schluter®-BARIN gutter system. Schluter®-BARIN is fastened to the balcony edging profile with screws. The screw slots in the gutter are elongated, making it possible to slope the gutter up to 1-3/16" (30 mm).

Matching inside corners, outside corners, and connector pieces are available for Schluter®-BARA-RTP.

Gutter System

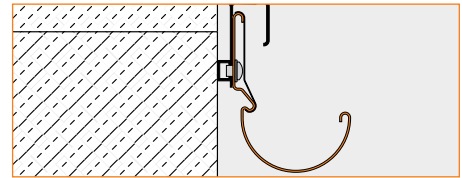

10.1 Schluter®-BARIN is a gutter system for the drainage of balconies and terraces. In addition to the Schluter®-BARIN gutter components, all required accessories, such as mounting screws, inside and outside corners, connectors, end caps, down couplings, down pipes, and spouts, are available. Schluter®-BARIN is attached with mounting screws to the balcony edging profiles, Schluter®-BARA-RTK and -RTP. Elongated slots at the back of the gutters allow for a slope of up to 1-3/16" (30 mm). All Schluter®-BARIN system accessories are fastened to the gutter with connectors.



Schluter®-BARIN gutter components, including covers, end caps, corners, and connectors, are made of color-coated aluminum.

Base Support Profile

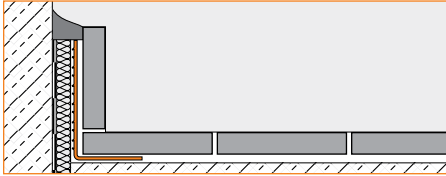

5.1 Schluter®-BARA-ESOT is a stainless steel right-angle support profile for attaching base tiles to non-load-bearing substrates. These substrates include metal flashing or bituminous waterproofing layers that are used at floor/wall transitions on balconies and terraces. A foam insulation strip, cut to the same height as the base tile, is placed between the vertical leg of the profile and the wall to prevent a force-conductive bond.

The trapezoid-perforated anchoring leg of Schluter®-BARA-ESOT is anchored between the setting bed and the tile. The special perforations of the vertical leg position Schluter®-BARA-ESOT approximately 1/32" (1 mm) from the insulating strip and promote a mechanical bond between the thin-set mortar and vertical leg.

Base tiles installed on Schluter®-BARA-ESOT will resist normal impact caused by brooms or mops.

Adhesive/Sealant

8.3 Schluter®-KERDI-FIX is a single-component, waterproof sealing and bonding compound with a silane-modified polymer base. Schluter®-KERDI-FIX is used to bond Schluter®-KERDI to fixed building elements such as balcony and terrace doors, window elements, sheet metal covers, and Schluter®-BARA edge profiles, and is suitable for sealing movement joints.

Material Properties and Areas of Application

In special cases, the suitability of Schluter®-BARA-/BARIN profiles must be verified based on the anticipated chemical, mechanical, and/or other stresses.

Color-coated aluminum BARA/BARIN profiles consist of pre-treated (chromated) color-coated aluminum, which is roll-formed

Schluter®-KERDI-FIX Technical Data

Color	Grey or bright white
Basic raw material	Silyl-modified polymer (SMP)
Specific weight	approx. 93.6 lb/ft ³ (1.5 g/ml)
Solvent content	0%
Isocyanate content	0%
Dry materials content	approx. 100%
VOC emissions	0.0 mg/m ³
Shear strength beech wood/beech wood	approx. 435 psi (3 N/mm ²)
Shear strength aluminum/aluminum	approx. 290 psi (2 N/mm ²)
Elongation at failure	approx. 200%
Skinning	about 10 minutes
Curing	1/8" (3 mm) per 24 hours
Permissible total movement	about 20%
Processing temperatures	don't install at temperatures below 40 °F (5 °C)
Temperature stability	-40 °F (-40 °C) to 212 °F (100 °C), temporarily 356 °F (180 °C) [max. 30 minutes]
Moisture resistance	very good
Frost ability	not sensitive to frost
Cartridge volume	9.81 oz (290 ml)
Sausage tube volume	20.29 oz (600 ml)
Estimated coverage	
5" (12.7 cm) connection to fixed building elements	12' 10" (3.9 m) per cartridge 26' 6" (8.1 m) per sausage tube
1/4" bead	30' 1" (9.2 m) per cartridge 62' 2" (18.9 m) per sausage tube

from aluminum sheets. The coating on the aluminum is color-stable, as well as UV- and weather-resistant. Visible surfaces should be protected against abrasion. Cementitious materials, in conjunction with moisture, become alkaline. Since aluminum is sensitive to alkaline substances, exposure to the alkali (depending on the concentration and duration of exposure) may result in corrosion (aluminum hydroxide formation). Therefore, it is important to remove mortar or grout residue from visible surfaces. In addition, ensure that the profile is solidly embedded in the setting material and that all cavities are filled to prevent the collection of alkaline water. Similarly, any penetrating water must be prevented from collecting in the mortar bed where the Schluter®-BARA profiles have been anchored. To ensure this, install the Schluter®-TROBA or Schluter®-TROBA-PLUS sub-surface drainage system.

Stainless steel BARA profiles are made from roll-formed stainless steel, type 304 (1.4301 = V2A), and can withstand high chemical and mechanical stresses. Base tiles installed on Schluter®-BARA-ESOT will resist normal impact caused by brooms or mops.

Schluter®-KERDI-FIX is odorless, as well as weather- and UV-resistant, making it especially suitable for exterior use. The adhesive is flexible, free of solvents, and provides a strong bond to most materials, including wood, stone, concrete, metal, glass, and many synthetic materials. Schluter®-KERDI-FIX can be used as an adhesive and waterproofing compound and is also suitable for sealing movement joints. Schluter®-KERDI-FIX can be painted over with most alkyd resins or dispersion paint types.

The suitability of the material must be verified based on the anticipated chemical, mechanical, and/or other stresses.

Installation

For complete installation details and warranty criteria for Schluter®-DITRA and Schluter®-DITRA-XL in exterior applications, please contact Schluter®-Systems for a copy of the Schluter®-DITRA Installation Handbook (USA: 800-472-4588; Canada: 800-667-8746), or download it from our website at: www.schluter.com.



5.3 Schluter®-BARA-RW

1. Select Schluter®-BARA-RW according to the thickness of the setting bed (i.e., the height of the floor assembly to be covered). Prefabricated corners and connectors are available for inside corners, outside corners, and butt joints. Abut the ends of the profile, leaving an approx. 3/16" (5 mm) joint. Cover the joint with the clip-on connector.
2. Using a notched trowel, apply thin-set mortar to the area where BARA-RW is to be placed. Press the perforated anchoring leg of the profile into the thin-set mortar and align.
3. To integrate the Schluter®-DITRA or Schluter®-DITRA-XL uncoupling membranes, abut the DITRA/DITRA-XL to the edge of the anchoring leg. The remaining joint between the uncoupling membrane and the profile is covered with Schluter®-KERDI-BAND; the KERDI-BAND must overlap the DITRA/DITRA-XL by a minimum 2" (5 cm) and cover the anchoring leg of the BARA-RW. Use Schluter®-KERDI-FIX to bond KERDI-BAND to the BARA-RW between the trapezoid perforations and the leading edge of the profile. Use unmodified thin-set mortar to bond KERDI-BAND to DITRA/DITRA-XL and the remaining area of the BARA-RW.
4. Tiles shall be laid in such a way that they extend approximately 3/4" (20 mm) beyond the edge of the profile. When using a trim profile at the edge area, the trim profile must extend beyond the Schluter®-BARA-RW by approximately 5/16" (8 mm).

5.15 Schluter®-BARA-RWL

1. Select Schluter®-BARA-RWL according to the height of the floor construction to be covered. Prefabricated corners and connectors are available for inside and outside corners. Abut the profile ends of Schluter®-BARA-RWL, leaving an approx. 3/16" (5 mm) joint. Cover the joint with the clip-on connector.
2. Before the drainage membranes (Schluter®-TROBA or Schluter®-TROBA-PLUS) are installed, set the trapezoid-perforated anchoring leg of the finishing profile, Schluter®-BARA-RWL, onto the waterproofing layer and, if required, adjust to the proper height and alignment with dots of mortar.

3. If Schluter®-BARA-RWL is used as a gravel edge profile, the gravel layer should abut the vertical profile leg just below the upper lip. The concrete pavers are laid loosely on top of the leveled gravel layer.
4. If Schluter®-BARA-RWL is used as a finishing profile in conjunction with stilted floor coverings, the profile covers the exposed edge of the covering assembly. The support pedestals are laid on top of the trapezoid-perforated anchoring leg of Schluter®-BARA-RWL. The concrete pavers are then set onto the pedestals.

Note: To ensure unobstructed drainage at the edge areas of the covering, make certain during installation that drainage openings in the drainage membrane and profile and that spaces between the pedestals remain open.

5.4 Schluter®-BARA-RK

1. At the edge area, Schluter®-BARA-RK is positioned into a layer of mortar. Prefabricated corner pieces are available for inside and outside corners. Abut the ends of the profile, leaving an approximate 3/16" (5 mm) joint. Cover the joint with the clip-on connector.
2. Balcony and terrace surfaces shall be filled with mortar to the height at which the mortar bed's reinforcement wire is placed. The reinforcing mesh (2" x 2" (50 mm x 50 mm); 16/16 wire) must overlap the anchoring leg of the profile.
3. To establish the correct plane for the setting bed, the mortar is applied at the appropriate height and slope using the upper edge of Schluter®-BARA-RK as a screeding guide. If Schluter®-DITRA or Schluter®-DITRA-XL is to be installed, the screed is leveled 1/8" (3 mm) or 5/16" (7 mm), respectively, below the top of the profile and carefully compacted.
4. Schluter®-TROBA or Schluter®-TROBA-PLUS must be incorporated as a drainage layer between the waterproofing layer and the mortar bed. Schluter®-BARA-RK effectively conceals the gap between the waterproofing and the mortar bed created by the installation of the drainage layer.
5. Tiles shall be laid in such a way that they extend approximately 3/4" (20 mm) beyond the edge of the profile. When using a trim profile at the edge area,

the trim profile must extend beyond the Schluter®-BARA-RK by approximately 5/16" (8 mm).

5.5 Schluter®-BARA-RAK and 5.9 Schluter®-BARA-RTK

1. Using a notched trowel, apply thin-set mortar to the area where BARA-RAK/-RTK is to be placed. Press the perforated anchoring leg of the profile into the thin-set mortar and align.
2. To integrate the Schluter®-DITRA or Schluter®-DITRA-XL uncoupling membranes, abut the DITRA/DITRA-XL to the edge of the anchoring leg. The remaining joint between the uncoupling membrane and the profile is covered with Schluter®-KERDI-BAND; the KERDI-BAND must overlap the DITRA/DITRA-XL by a minimum 2" (5 cm) and cover the anchoring leg of the BARA-RAK/-RTK. Use Schluter®-KERDI-FIX to bond KERDI-BAND to the BARA-RAK/-RTK between the trapezoid perforations and the leading edge of the profile. Use unmodified thin-set mortar to bond KERDI-BAND to DITRA/DITRA-XL and the remaining area of the BARA-RAK/-RTK.
3. The tiles may now be installed using the thin-bed method. Schluter®-SCHIENE or Schluter®-RONDEC can be applied to edge the tiles at the recessed transition to the drip lip. Select SCHIENE/RONDEC size according to tile thickness; larger size will be required when used with DITRA-XL. If the SCHIENE or RONDEC will not be used, the edge of the covering assembly should be approximately flush with the drip lip of Schluter®-BARA-RAK/-RTK.
4. When using a bituminous, flat sheet-applied, or trowel-applied waterproofing membrane, the trapezoid-perforated anchoring leg of Schluter®-BARA-RAK or -RTK is bonded to the sloped screed at the exposed edge area with a suitable thin-set mortar. To prevent a slope reduction at the edge area, apply a gradient transition layer of thin-set mortar between the screed and the profile. The waterproofing membrane is carried over the cut-back channels in the bonding flange and bonded with a suitable adhesive. When installing the waterproofing membrane, the instructions of the manufacturer must be observed.
5. Covering assemblies installed over a



waterproofing layer may consist of a drainage membrane with a load-distribution layer (e.g., mortar bed) on top, a gravel layer, or large-format pavers supported by pedestals or stilts.

- Please note: Prefabricated corners and connectors are available for inside corners, outside corners, and butt joints. Abut the ends of Schluter®-BARA-RAK or -RTK, leaving an approx. 3/16" (5 mm) joint. Cover the joint with the clip-on connector.
- For BARA-RTK: Once the covering is completely installed, the Schluter®-BARIN gutter system can be fastened to the Schluter®-BARA-RTK profile using the included screws. The slotted holes allow for establishing the proper slope, if required.

5.11 Schluter®-BARA-RTP

- To fasten the Schluter®-BARA-RTP edging profile, drill 5/16" (8 mm) -diameter holes into the fascia at approximately 20" (50 cm) intervals. To align with the holes provided in the profile, Schluter®-BARA-RTP can be placed against the fascia and used as a drilling template.
- After inserting the anchors, the Schluter®-BARA-RTP edging profile should be fastened with Schluter®-BARA-RTPS 540 special bolts (provided). To properly fasten Schluter®-BARA-RTP to the fascia, it is advisable, beforehand, to fill the rear section of the edging profile with thin-set mortar.
- Once Schluter®-BARA-RTP has been mounted, the Schluter®-BARIN gutter system can be attached. To do this, fasten the Schluter®-BARIN gutter to the Schluter®-BARA-RTP edging profile with screws. Schluter®-BARIN features slotted holes for establishing the proper slope.
- Please note: Prefabricated corners and connectors are available for inside corners, outside corners, and butt joints. Abut the ends of Schluter®-BARA-RTP, leaving an approx. 3/16" joint. Cover the joint with the clip-on connector.

10.1 Schluter®-BARIN

- Schluter®-BARIN gutter components are cut to size and attached to the Schluter®-BARA profile with the included

screws. Elongated slots allow for a slope, if required.

- To waterproof the connection between two gutter sections, center a connector over the seam. The rubber gasket in the connector provides a waterproof seal.
- The end caps are held against the gutter from below and fastened with a connector.
- Screws and elongated slots are concealed by clipping on a cover profile.

5.1 Schluter®-BARA-ESOT

- Apply a foam insulation strip to the wall at the height of the tile base.
- Using a notched trowel, apply thin-set mortar over the floor area where the profile is to be placed.
- Embed the horizontal anchoring leg of Schluter®-BARA-ESOT into the mortar while pressing the vertical leg of the profile against the insulation strip.
- Trowel additional thin-set mortar over the anchoring leg and embed the floor tiles into the mortar, ensuring full coverage and support of the tile.
- Apply thin-set mortar to the back of the base tiles and attach them to the vertical leg of the profile. The mortar must penetrate the profile perforations to ensure firm adhesion of the base tiles. Prior application of the foam strip prevents a force-conductive bond to the wall. A joint of approximately 3/16" (5 mm) should be left between the floor tile and the base tile. The joint must then be filled completely with grout or setting material.
- Seal the wall connection above the base tile with an appropriate sealing compound.
- Please note: The height of the base tile must either meet or exceed the height of the support profile's vertical leg. However, the foam insulation strip must be applied at full base tile height.

8.3 Schluter®-KERDI-FIX

- The substrate may be slightly moist, but must be free of components that may impede adhesion. In addition, it should be sufficiently solid and load bearing.
- Apply Schluter®-KERDI-FIX to the substrate and evenly distribute the adhesive with a small notched trowel.
- Adhere the KERDI-BAND or other material as quickly as possible over

the whole area to avoid skinning of the adhesive, making sure to avoid the formation of air bubbles.

- It is recommended to run the smooth side of the notched trowel, held at an angle, over the Schluter®-KERDI mat under pressure when installing KERDI, or to use a suitable pressure roller to carefully avoid air bubbles.

If Schluter®-KERDI-FIX is used as sealant, immediately smooth the surface after filling the joint. The surface of the joint should be cleaned at regular intervals.

Cleaning: Remove fresh adhesive with an appropriate cleaning agent; after curing, the adhesive can only be removed with mechanical methods.

Maintenance

Schluter®-BARA profiles and Schluter®-BARIN gutter system require no special maintenance or care.

The coatings on the **color-coated aluminum** profiles and gutter parts are colorfast and UV-resistant. Damaged surfaces shall be painted over.

Stainless steel surfaces exposed to the environment or aggressive substances should be cleaned periodically using a mild household cleaner. Regular cleaning maintains the neat appearance of stainless steel and reduces the risk of corrosion. All cleaning agents must be free of hydrochloric and hydrofluoric acid. Stainless steel surfaces develop a sheen when treated with a chrome-polishing agent.

Unopened packages of **Schluter®-KERDI-FIX** can be stored in a cool place for up to 18 months. Once the cartridge has been opened, the material has a limited shelf life.



Product Item Numbers

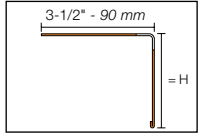

Outside corner

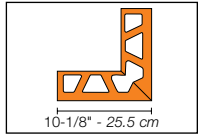

Connector

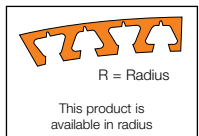
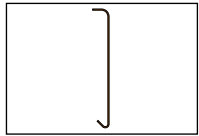

5.3 Schluter®-BARA-RW

H = in. - mm	Item No.	
	Stainless steel 304 (1.4301 = V2A) (E)	Aluminum, color-coated
9/16" - 15 mm	RW 15 E	RW 15 <i>color*</i>
1" - 25 mm	RW 25 E	RW 25 <i>color*</i>
1-3/16" - 30 mm	RW 30 E	RW 30 <i>color*</i>
1-9/16" - 40 mm	RW 40 E	RW 40 <i>color*</i>
2-3/16" - 55 mm	RW 55 E	RW 55 <i>color*</i>
3" - 75 mm	RW 75 E	RW 75 <i>color*</i>
3-3/4" - 95 mm	RW 95 E	RW 95 <i>color*</i>
4-3/4" - 120 mm	RW 120 E	RW 120 <i>color*</i>
6" - 150 mm	RW 150 E	RW 150 <i>color*</i>

Length supplied: 8' 2-1/2" — 2.50 m

5.3 Schluter®-BARA-RW

Accessories	Item No.
Outside corner, 90°	E 90 / <i>profile item number*</i>
Connector	V / <i>profile item number*</i>

*Color Codes



To complete the item number, add the *color* code (e.g., RW 15 **SB**).



How to order corners:

*To complete the item number for corners, add the corresponding *profile item number* (e.g., E 90 / RW 15 E).

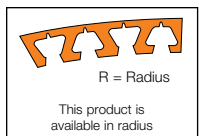
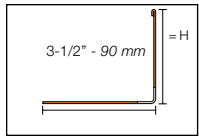

5.15 Schluter®-BARA-RWL

H = in. - mm	Item No.
	Aluminum, color-coated
9/16" - 15 mm	RWL 15 <i>color*</i>
1" - 25 mm	RWL 25 <i>color*</i>
1-3/16" - 30 mm	RWL 30 <i>color*</i>
1-9/16" - 40 mm	RWL 40 <i>color*</i>
2-3/16" - 55 mm	RWL 55 <i>color*</i>
3" - 75 mm	RWL 75 <i>color</i>
3-3/4" - 95 mm	RWL 95 <i>color*</i>
4-3/4" - 120 mm	RWL 120 <i>color*</i>
6" - 150 mm	RWL 150 <i>color*</i>

Length supplied: 8' 2-1/2" — 2.50 m

*Color Code



To complete the item number, add the *color* code (e.g., RWL 65 **PG**).



5.4 Schluter®-BARA-RK

Item No.

Aluminum,
color-coated

RK 65 *color**

Length supplied: 8' 2-1/2" — 2.50 m

***Color Codes**



To complete the item number, add the *color* code (e.g., RK 65 **SB**).

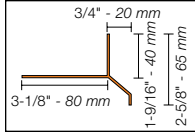

Outside corner, 90°

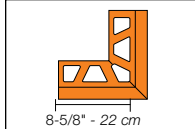

Outside corner, 135°

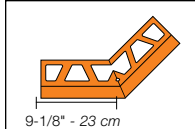

Inside corner, 90°

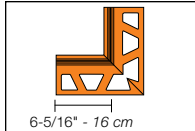

Connector

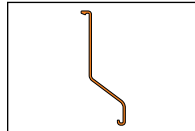

5.5 Schluter®-BARA-RAK

Item No.

Aluminum,
color-coated

RAK 50 *color**

Length supplied: 8' 2-1/2" — 2.50 m

***Color Codes**



To complete the item number, add the *color* code (e.g., RAK 50 **SB**).

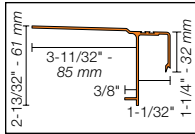

Outside corner, 90°

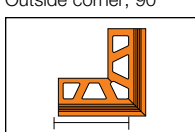

Outside corner, 135°

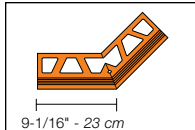

Inside corner, 90°

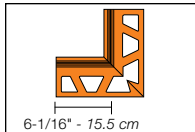

Connector

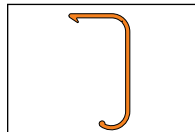

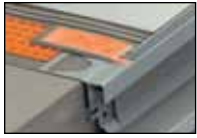

5.9 Schluter®-BARA-RTK

Item No.

Aluminum,
color-coated

RTK 30 *color**

Length supplied: 8' 2-1/2" — 2.50 m

***Color Codes**



To complete the item number, add the *color* code (e.g., RTK 30 **SB**).

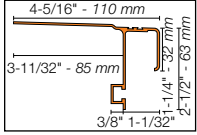

3/8" - 10 mm, 1-1/32" - 26 mm

Outside corner, 90°

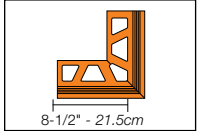

Outside corner, 135°

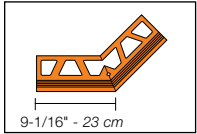

Inside corner, 90°

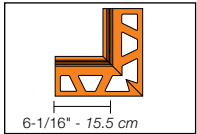

6-1/16" - 15.5 cm

Connector

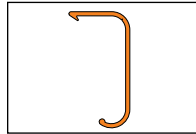

Outside Corner 90°



Inside Corner 90°



Outside Corner 135°



Connector



5.11 Schluter®-BARA-RTP

Item No.

Aluminum,
color-coated

RTP 65 *color**

Length supplied: 8' 2-1/2" — 2.50 m

***Color Code**



To complete the item number, add the *color* code (e.g., RTP 65 **PG**).

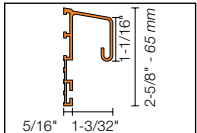

5/16" - 8 mm, 1-1/16" - 27 mm,
1-3/32" - 28 mm

Outside corner, 90°

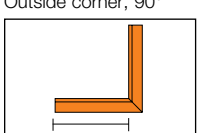

Outside corner, 135°

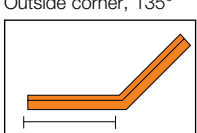

Inside corner, 90°

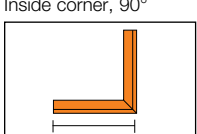

9-1/2" - 24 cm

Connector

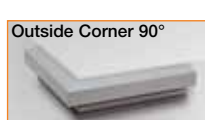
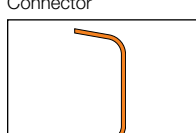

Outside Corner 90°



Inside Corner 90°



Outside Corner 135°



Connector



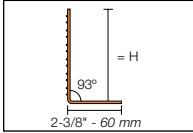
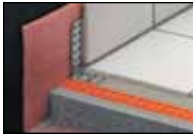

5.1 Schluter®-BARA-ESOT

H = in. - mm	Item No.
	Stainless steel 304 (1.4301 = V2A) (E)
2-3/8" - 60 mm	ESOT 60
4-3/8" - 110 mm	ESOT 110

Length supplied: 8' 2-1/2" - 2.50 m



8.3 Schluter®-KERDI-FIX (sealant)

Item No.	Cartridge Volume
KERDIFIX / <i>color*</i>	9.81 oz (290ml)

*Color Codes



To complete the item number, add the *color* code (e.g., KERDIFIX / *BW*).



8.3 Schluter®-KERDI-FIX (sealant)

Item No.	Cartridge Volume
KERDIFIX/SB/G	20.29 oz (600ml)

Schluter®-BARA-STU

Item No.	Length	Width	Thickness
STU 335 + <i>color*</i>	13" (33 cm)	2" (5 cm)	1/64" (0.5 mm)

*Color Codes



To complete the item number, add the *color* code (e.g., STU 335 *SB*).

Note: Schluter®-BARA-STU are thin strips of colored aluminum sheets, which can be cut to length with scissors and adhered with silicone as joint covers for the Schluter®-BARA profile series.

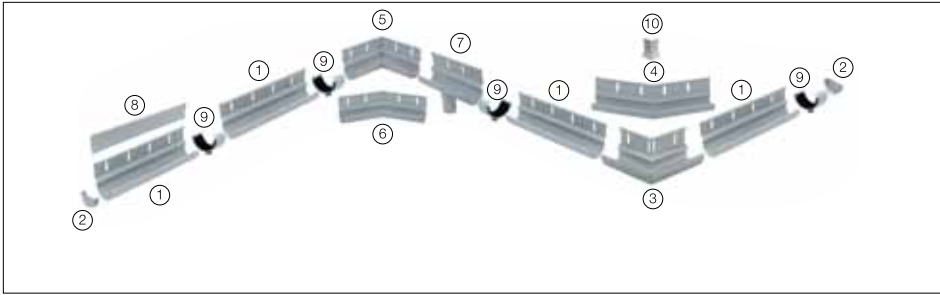
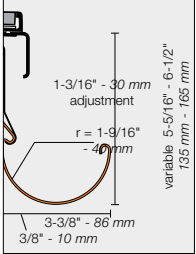

10.1 Schluter®-BARIN-SR

Gutter system (color-coated aluminum)	Item No.
BARIN Gutter set, 8' 2" - 2.50 m (1) 1 Gutter, 8' 2" - 2.50 m (8) 1 of each, Cover profile, 8' 2" - 2.50 m & 1' 7" - 0.50 m (9) 1 Connector 6 Screws	BSR4 R 250 color*
BARIN Gutter set, 4' 11" - 1.50 m (1) 1 Gutter, 4' 11" - 1.50 m (8) 1 of each, Cover profile, 4' 11" - 1.50 m & 1' 7" - 0.50 m (9) 1 Connector 4 Screws	BSR4 R 150 color*
BARIN End cap set (2) 2 End caps (9) 2 Connectors	BSR4 E 2 color*
BARIN 90° Outside corner set (3) 1 Corner (9) 2 Connectors (10) 1 Cover profile corner	BSR4 EWG 90 color*
BARIN 135° Outside corner set (4) 1 Corner (9) 2 Connectors (10) 1 Cover profile corner	BSR4 EWG 135 color*
BARIN 90° Inside corner set (5) 1 Corner (9) 2 Connectors	BSR4 IWG 90 color*
BARIN 135° Inside corner set (6) 1 Corner (9) 2 Connectors	BSR4 IWG 135 color*
BARIN Down coupling set (7) 1 Gutter, 7-7/8" - 20 cm with connection to downspout (9) 2 Connectors 2 Screws	BSR4 A DN 60 color*

***Color Codes**

BW Bright white	HB Light beige	PG Classic grey	GM Metallic grey
RB Red brown	SB Black brown		

To complete the item number, add the **color** code (e.g., BSR4 R 250 **RB**).

Note: Slight color variations may occur due to material differences in system components.

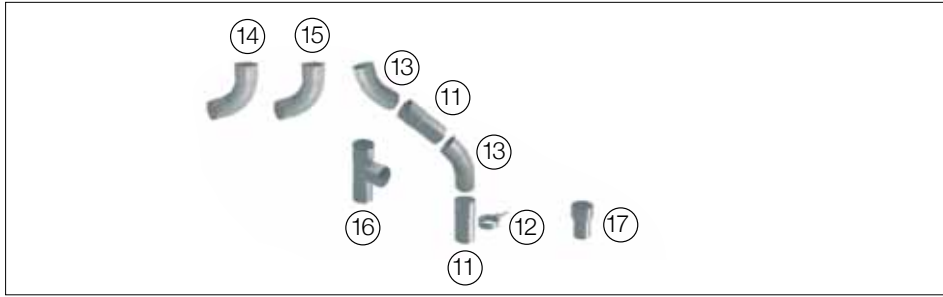

10.1 Schluter®-BARIN-R

Pipe systems (color-coated aluminum)	Item No.
Down pipe (11) 3' 3" - 1 m (11) 8' 2" - 2.50 m	BR 100 DN 60 color* BR 250 DN 60 color*
Pipe clamp set (12) 2 Pipe clamps, Anchoring screws 3-15/16" - 100 mm (12) 2 Pipe clamps, Anchoring screws 7-7/8" - 200 mm	BR RS 100 DN 60 color* BR RS 200 DN 60 color*
Anchoring screws for pipe clamps 7-7/8" - 200 mm	BR SS 200
Elbow pipes (13) 40° ø 2-23/64" - 60 mm (14) 72° ø 2-23/64" - 60 mm (15) 85° ø 2-23/64" - 60 mm	BR B40 DN 60 color* BR B72 DN 60 color* BR B85 DN 60 color*
Tee pipes (16) 2-23/64" - 60 mm	BR AZ DN 60 color*
(17) Coupling	BR AM DN 60 color*

Note: The standard design of each downpipe features a connection socket. The slip-on coupling (18) can be used to connect two Schluter®-BARIN pipes without the connection socket (i.e., cut pieces). Spouts (17) are designed to integrate directly with the BARIN down coupling (7).

*Color Codes



To complete the item number, add the **color** code (e.g., BR 100 DN 60 **RB**).

Note: Slight color variations may occur due to material differences in system components.

Schluter®-Systems Balcony and Terrace Profiles 5-Year Limited Warranty

COVERAGE AND CONDITIONS: Subject to the conditions and limitations as stated hereinafter, **Schluter-Systems*** warrants that **Schluter®-Systems Balcony and Terrace Profiles** (the "Products")** will be free from manufacturing defects for a period of five (5) years from the date of purchase and only when the Products are used and installed in accordance with the terms and conditions of the Schluter®-Systems Balcony and Terrace Profiles Technical Data Sheet and industry standard guidelines that are not in conflict with the Data Sheet in effect at the time of installation. It is the responsibility of the owner/builder/installer to ensure the suitability of all building materials and all associated building materials for the owner's intended use. Visual defects or nonconformities apparent prior to installation are not covered by this warranty. Further, this warranty does not cover normal wear and tear or other damage (e.g., scratches, discoloration, fading, etc.) caused by impacts or accidents. It is recommended that the owner consult an experienced and professional installer.

RESOLUTION: If the Products fail to meet this warranty, then the owner's exclusive remedy and the sole obligation of Schluter-Systems, at its election, shall be to a) reinstall or replace the failed portion of the tile assembly or b) pay an amount not to exceed the original square foot cost of the installation of the tile assembly verified to be defective. Tile assembly is defined to include all Schluter®-Systems Balcony and Terrace Profiles, non-reusable tile surfaces, and the appropriate setting and grouting materials. Further, due to conditions beyond the control of Schluter-Systems (e.g., color and shade availability, discontinuation, normal wear and tear), Schluter-Systems cannot guarantee or warrant an exact match to the specific tile, stone, or other flooring materials used in the installation. In such events, substantially similar materials may be substituted.

DISCLAIMER: THERE ARE NO WARRANTIES BEYOND THIS EXPRESSED WARRANTY AS STATED ABOVE. ALL OTHER WARRANTIES, REPRESENTATIONS OR CONDITIONS, EXPRESSED OR IMPLIED, ARE DISCLAIMED AND EXCLUDED, INCLUDING WARRANTIES, REPRESENTATIONS OR CONDITIONS OF **MERCHANTABILITY** OR FITNESS FOR A PARTICULAR PURPOSE ARISING BY STATUTE OR OTHERWISE BY LAW OR FROM A COURSE OF DEALING OR USAGE OF TRADE. SCHLUTER-SYSTEMS EXCLUDES AND IN NO EVENT SHALL HAVE ANY LIABILITY FOR LOST PROFITS OR ANY OTHER INDIRECT, SPECIAL, INCIDENTAL, PUNITIVE, EXEMPLARY, OR CONSEQUENTIAL DAMAGES, ARISING OUT OF OR OTHERWISE CONNECTED TO FAILURE OF THE PRODUCTS OR TILE ASSEMBLY OF WHICH THEY ARE PART, NOR MISUSE OF THE PRODUCTS OR TILE ASSEMBLY, REGARDLESS OF ANY STRICT LIABILITY, ACTIVE OR PASSIVE NEGLIGENCE OF SCHLUTER-SYSTEMS, AND REGARDLESS OF THE LEGAL THEORY (CONTRACT OR TORT OR EXTRA-CONTRACTUAL OR OTHER), NOR FROM ACTS OF WAR, TERRORISM, FAULTY AND NEGLIGENT PENETRATION OF THE SYSTEM, FIRES, EXPLOSIONS, ACTS OF GOD, INTENTIONAL ACTS OF DESTRUCTION OR ANY LOSSES DUE TO STRUCTURAL FAILURE OR OTHER CAUSES UNRELATED TO THE PRODUCTS OR DELAYS, OR ANY OTHER INCIDENTAL OR CONSEQUENTIAL DAMAGES. THIS WARRANTY IS GIVEN IN LIEU OF ANY OTHER WARRANTY EXPRESSED OR IMPLIED. THE REMEDIES CONTAINED HEREIN ARE THE ONLY REMEDIES AVAILABLE FOR BREACH OF THIS WARRANTY. THIS LIMITED WARRANTY GIVES YOU SPECIFIC LEGAL RIGHTS, SOME STATES AND PROVINCES DO NOT ALLOW DISCLAIMERS OR OTHER RESTRICTIONS OF IMPLIED WARRANTIES SO SOME OF THE ABOVE LIMITATIONS MAY NOT APPLY TO YOU.

TRANSFERABILITY: This Limited Warranty extends ONLY to the original end user (defined as original intended owner and user of the property/unit in which the installation is incorporated - herein referred to as "Owner") and is not transferable or assignable, unless approved in writing by the Technical Director or an Officer of Schluter-Systems or otherwise prohibited by specific state or provincial law.

MODIFICATIONS TO WARRANTY: No changes or modification of any terms or conditions of this warranty are allowed unless authorized by written agreement and signed by the Technical Director or an Officer of Schluter-Systems.

EFFECTIVE DATE: This warranty shall supersede and replace any and all prior oral or written warranties, agreements, or other such representations made by or on behalf of Schluter-Systems relative to the Products or the application of the Products and shall apply to any installation occurring on or after January 1, 2013.

CLAIMS ON THIS LIMITED WARRANTY: To make a claim under this Limited Warranty, the Owner must provide Schluter-Systems with written notice within 30 days of any alleged defect in the Products covered by this Limited Warranty, together with date and proof of purchase of the Products, proof of the costs of the original installation and name and address of all installers, failing which this Limited Warranty shall be of no legal effect. Schluter-Systems reserves the right at its election and as a condition of this Limited Warranty to inspect the alleged failed and defective condition.

All U.S. Claims shall be sent to:

Schluter Systems L.P.
Attn: Warranty Claims Dept.
194 Pleasant Ridge Road
Plattsburgh, NY 12901-5841

All Canadian Claims shall be sent to:

Schluter Systems (Canada), Inc.
Attn: Warranty Claims Dept.
21100 chemin Ste-Marie
Ste-Anne-de-Bellevue, QC H9X 3Y8

*For the purpose of this warranty **Schluter Systems, L.P.** shall provide the warranty for all products for end users located in the United States, and **Schluter Systems (Canada) Inc.** shall provide the warranty for all products for end users located in Canada. This warranty is limited to sales of the Products made in and intended for use in the United States and Canada.

****Schluter®-Systems Balcony and Terrace Profiles (the "Products"):** The Products are defined to include all Schluter®-Systems balcony profiles and terrace profiles referred to in the Schluter®-Systems Balcony and Terrace Profiles Data Sheet.



Schluter Systems L.P. • 194 Pleasant Ridge Road, Plattsburgh, NY 12901-5841 • Tel.: 800-472-4588 • Fax: 800-477-9783
Schluter Systems (Canada) Inc. • 21100 chemin Ste-Marie, Ste-Anne-de-Bellevue, QC H9X 3Y8 • Tel.: 800-667-8746 • Fax: 877-667-2410
info@schluter.com

www.schluter.com