



OPERATOR'S MANUAL

Cordless Roll & Spray

This product is covered by U.S. patents and other international patents

Copyright. All Rights Reserved.

Model LRS70036

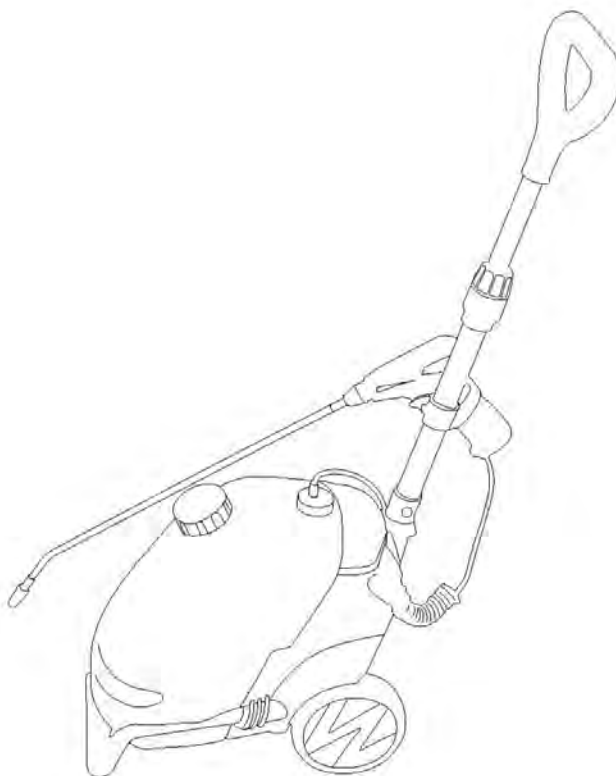

This product has been engineered and manufactured to our high standard for dependability, ease of operation, and operator safety. Properly cared for, it will give you years of rugged, trouble-free performance.

WARNING: To reduce the risk of injury, the user must read and understand the operator's manual before using this product.

BATTERY MUST BE CHARGED BEFORE FIRST USE.

Thank you for your purchase.

DO NOT RETURN THIS PRODUCT TO THE STORE. OPERATING, ASSEMBLY, PARTS, SERVICE QUESTIONS?
CALL 1-800-313-5111 BETWEEN 7:30AM-4:30PM EST FOR ASSISTANCE

SAVE THIS MANUAL FOR FUTURE REFERENCE

Product Specifications

Model LRS 70036

Input. 3.6V DC
 Battery Type Lithium-ion
 Lithium-ion Battery capacity. 2000mAH
 Charger (adaptor) input. 120V, 60 Hz AC
 Battery charging time. 1.5 hours
 Tank capacity. 3 Gallon (11.3 Liter)

Parts List

1	Handle	i	Safety lock
2	Telescopic tube	4	Fill cap
3	Spray gun assy. Including:	5	Tank
a	Leaking plug	6	Tank support
b	Suction tube	7	Holster
c	Filter	8	Wheel
d	Trigger	9	Extension misting wand
e	Spring tube	10	Battery Charger
f	Cap	11	Charge-control indicator
g	Clip	12	Charging inlet
h	Nozzle	13	Plug connector for charger

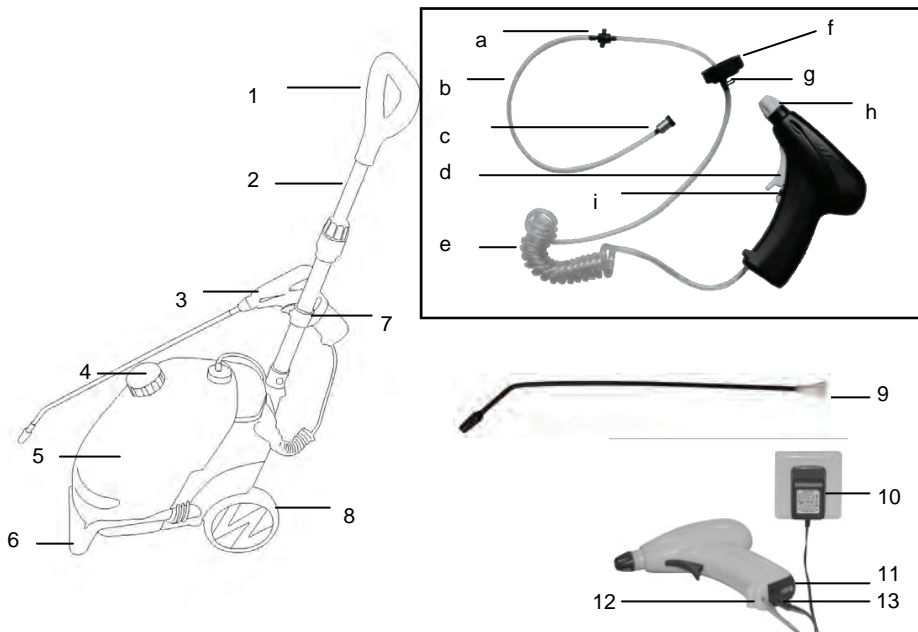

Packing List

Carefully remove the garden sprayer from its packaging and check that the below contents are included:

- Tank assembled with bracket, filling cap, etc.
- Spray gun assembled with spring tube and suction tube
- Telescopic tube
- Handle
- Extension misting wand
- Battery charger
- Bag with 3 screws and nuts
- Operating instructions

Explanation of Symbols



Warning notice



Read the instruction manual.



Do not expose the garden sprayer to rain.



Only use the battery charger indoors.



Battery charger contains a safety transformer

Charging the battery

- The battery should be fully charged before using for the first time. The charging time is about 1.5 hours.
- The battery charger supplied matches the lithium battery installed in the Roll & Spray garden sprayer. DO NOT use any other charger to recharge the garden sprayer.
- To protect the lithium battery against deep discharging, when the battery is flat, the Roll & Spray garden sprayer will automatically switch off via a protective circuit.



If the trigger is used continually at this point, the lithium battery can be damaged. Do not try to continue to use the Roll & Spray garden sprayer before recharging the battery.

Charging Procedure

1. Insert the charger cable into charging inlet (12) on the sprayer gun.
 2. Making sure the wall outlet in your home is normal household voltage (AC120V 60Hz); insert the battery charger plug into the mains power supply.
 3. The red LED charging indicator (11) lights up to tell you that the battery pack is on charge. The battery is fully charged when the red LED charging indicator (11) turns off
- During the charging process, the spray gun assembly will warm up, but this is perfectly normal.
 - When not using the spray gun for extended periods, disconnect the battery charger from the socket.
 - When the Roll & Spray garden sprayer is charging, you must not attempt to use product.
 - Only charge the battery between 50°F-110°F (10°C-45°C)
 - After prolonged use, allow battery to cool down first before recharging.



SAFETY PRECAUTIONS



- Read all safety warnings and all instructions. Failure to follow the warnings and instructions may result in electric shock, fire and/or serious injury.
- Read, understand and follow original chemical manufacturer's directions, specifications and warnings.
- Only use with chemicals that are approved and recommended for battery operated garden sprayers.
- Never use flammable solvents, combustibles, extremely caustic solutions or oils.
- This garden sprayer should be used only by adults, keep away from children
- Do not spray towards yourself, other people, pets, electrical outlets or flames.
- The user is responsible for any accidents involving other people or anyone's property.
- Save all warnings and instructions for future reference.
- The term "garden sprayer" in the warnings refers to your battery operated (cordless) Roll & Spray garden sprayer.

Work Area

- Keep the work area clean and well lit, as cluttered and dark areas can result in accidents.
- Do not operate the garden sprayer in explosive atmospheres, such as in the presence of flammable liquids, gases or dust.
- While operating the garden sprayer, keep children and bystanders away as distractions can cause you to lose control.

Electrical Safety

- Make sure the power rating on the plug matches the outlet. (AC120V 60HZ)
- Never modify the plug in any way.
- Do not use any adaptor plugs with earthed (grounded) power tools. Unmodified plugs and matching outlets will reduce risk of electric shock.
- To prevent the risk of electric shock, when operating the garden sprayer avoid body contact with earthed or grounded surfaces, such as pipes, radiators, ranges or refrigerators. Never operate the garden sprayer in the rain.

Personal Safety

- Stay alert, watch what you are doing and use common sense when operating the garden sprayer. Do not use the garden sprayer while you are tired or under the influence of drugs, alcohol or medication. A moment of inattention while operating the garden sprayer may result in serious personal injury.
- To maintain full control of the garden sprayer, keep proper footing at all times with your weight evenly balanced over both feet and never overreach.
- Do not attempt to use garden sprayer while standing on a ladder.

Garden Sprayer use and care

- Do not use the garden sprayer if the power switch is faulty. Any tool that cannot be controlled with the switch is dangerous and must be repaired.
- When not in use store the garden sprayer out of reach of children, and do not allow persons unfamiliar with the garden sprayer (or these instructions) to operate it.
- To prevent the risk of accidents, periodically check the garden sprayer for damage.
- To ensure that the garden sprayer is safe, use only identical replacement parts.
- Keep the safety switch in lock position when not in use.



WARNING: The electrical cords on this product could contain chemicals known to the State of California to cause cancer and birth defects or reproductive harm. Wash hands after handling.

Battery/Battery charger safety warnings



- To prevent the risk of electric shock, protect the battery charger from rain and moisture.
- Recharge the battery only with the charger provided. A charger that is suitable for one type of battery pack may create a risk of fire when used with another battery pack.
- The supplied battery charger is only suitable for charging the Roll & Spray garden sprayer and to prevent the risk of fire and explosion must not be used for charging any other tool.
- Before each use check the battery charger, cable and plug for signs of damage. If the battery charger is damaged, do not use it or attempt to repair it. Damaged battery chargers, cables and plugs increase the risk of electric shock.

SAFETY PRECAUTIONS

- To prevent the risk of fire, do not operate the battery charger on a flammable surface (e.g. paper, textiles, etc.) or in combustible environments.
- If the Roll & Spray garden sprayer gun is dropped, or subjected to a hard impact, liquid can be ejected from the battery. Should this liquid accidentally contact your skin, immediately flush the area with water as it can cause irritation and even burns. Should the liquid contact your eyes you will also need to seek medical attention.
- To prevent the risk of short circuit, do not open the battery yourself.
- To prevent the risk of explosion, protect the battery from heat, such as continuous sunlight or fire.
- To prevent the risk of explosion, do not short-circuit the battery.
- If the battery becomes damaged due to improper use, vapor may be emitted. Should this happen get fresh air and consult a doctor should any respiratory complaint develop.

Assembling

1. Fitting telescopic tube to the body

Insert the telescopic tube into the hole on the body. Secure it with the nut and screw (Fig. 1)

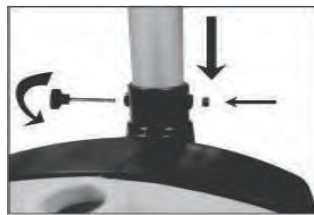

Fig. 1

2. Assembling the handle

Assemble handle to the telescopic tube. Make sure the 2 holes on the handle match the 2 holes on the telescopic tube (Fig.2), secure handle to the telescopic tube with 2 screws and nuts. (Fig.3)



Fig. 2



Fig. 3

3. Assembling the extension misting wand

Twist the nozzle counterclockwise to remove from spray gun (Fig. 4). Twist the extension wand clockwise to install on spray gun (Fig. 5).



Fig. 4

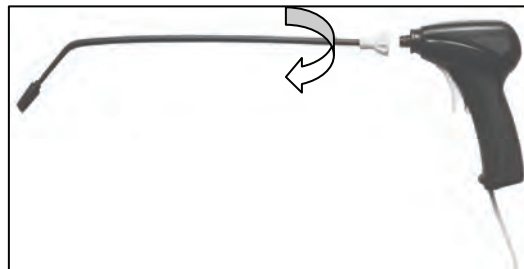

Fig. 5

Assembly

4. Install spray gun assembly to the tank.

Insert the suction tube into the tank. Screw the cap on securely. (Fig. 6)

Place the spray gun into the holster. (Fig. 7), tighten the strap (Fig. 8)



Fig. 6



Fig. 7



Fig. 8

5. Fit nozzle to the telescopic tube.

Two different nozzles are supplied with your Roll & Spray. To avoid unused nozzle from getting lost, we recommend attaching the unused nozzle to the telescopic tube when the wand is on spray gun.

A. Screw the nozzle clockwise (Fig. 9) onto the telescopic tube

B. Fit wand nozzle to telescopic tube (Fig. 10) when not in use



Fig. 9



Fig. 10

Operation

1. Starting:

Push the safety lock (i) down and squeeze the trigger (d) on the spray gun.

2. Stopping:

Release the trigger (d). Push the safety lock (i) up in the lock position when not in use.

3. Adjust nozzle:

Twist the nozzle to get stream or spray functions.

Maintenance



- Keep the safety switch in the lock position when not in use.
- Do not switch chemicals used in the garden sprayer without proper cleaning
- Do not store liquids in the tank. Follow chemical manufacturer's directions for storage and disposal.
- Make sure caps on the Tank are tight and secure at all times.
- Clean the filter (c) periodically to guarantee good performance.

Cleaning / Storage

- After use, rinse out spray gun and tank with clean water. Run water through the spray gun for 30 seconds while pressing trigger. If necessary you may remove both nozzles for cleaning if clogged.
- Charge the battery 1.5 hours before storing.
- During storage, charge the battery at least once every three months to protect it from damage.
- Store the garden sprayer in a dry, secure place out of reach of children.
- Do not place any other objects on top of the garden sprayer.
- The garden sprayer must not be stored in temperatures 35°C (95 °F) or in direct sunlight.
- Do not store the garden sprayer in places with static electricity.



Waste electrical products should not be disposed of with household waste. Please recycle where facilities exist. Check with your Local Authority or retailer for recycling advice.



This product contains a lithium-ion battery. Do not dispose of battery powered spray gun in household waste, water or fire. Spray gun must be collected, recycled or disposed of in an environmentally friendly way. Please dispose of properly at a public recycling facility.

WARRANTY

LIMITED WARRANTY FOR CORDLESS ROLL & SPRAY

This product is manufactured for The Great States Corporation/American Lawn Mower Company. The Great States Corporation/American Lawn Mower Company, Shelbyville, Indiana, has been making lawn mowers for over 100 years and it warrants to the original owner that each new product and service part is free from defects in material and workmanship and agrees to repair or replace under this warranty any defective product or part from the original date of purchase for one (1) year except for the conditions and circumstances listed below. Proof of purchase (original dated sales receipt) must accompany all warranty claims.

THIS WARRANTY IS NOT TRANSFERABLE AND DOES NOT COVER:

Products sold damaged or incomplete, sold "as is", sold reconditioned, or used as rental equipment.

Delivery, installation, or normal adjustments explained in the operator's manual.

Damage or liability caused by shipping, improper handling, improper installation, incorrect voltage or improper wiring, improper maintenance, improper modification, or the use of accessories and/or attachments not specifically recommended.

Repairs necessary because of operator abuse or negligence, or the failure to install, operate, maintain, or store the product according to the instructions in the operator's manual.

Damage caused by cold, heat, rain, excessive humidity, corrosive environments and materials, or other contaminants.

Expendable items that become worn during normal use.

Cosmetic defects that do not interfere with product functionality.

Freight costs from customer to vendor.

Repair and transportation costs of products or parts determined not to be defective.

ANY INCIDENTAL, INDIRECT, OR CONSEQUENTIAL LOSS, DAMAGE, OR EXPENSE THAT MAY RESULT FROM ANY DEFECT, FAILURE, OR MALFUNCTION OF THE PRODUCT. Some states do not allow the exclusion or limitation on how long an implied warranty lasts, so the above limitations may not apply to you.

ANY NON-RESIDENTIAL USE OR COMMERCIAL USE VOIDS ALL WARRANTIES.

CALL US FIRST !!

Call us first with questions about operating or maintaining this product at 1.800.313.5111 between 7:30 a.m. – 4:30 p.m. Eastern Standard Time, or send emails to earthwise@reelin.com.



The Great States Corporation
American Lawn Mower Company
830 Webster Street
Shelbyville, IN 46176
Phone 1-800-313-5111
www.reelin.com/earthwise

In a continued commitment to improve quality, the Manufacturer reserves the right to make component changes or design changes when necessary.