

2190 Dagenais Blvd. West Tel. : 514.337.4415
Laval (Quebec) Fax : 514.337.4029
Canada info@burcam.com
H7L 5X9 see us at www.burcam.com

MODEL 300509PS

HIGH CAPACITY AUTOMATIC SUBMERSIBLE UTILITY PUMP

Your pump has been carefully packaged at the factory to prevent damage during shipping. However, occasional damage may occur due to rough handling. **Carefully inspect your pump** for damages that could cause failures. Report any damage to your carrier or your point of purchase.

Please read these instructions carefully. **Failure** to comply to instructions and **designed** operation of this system, may **void** the warranty.

NOTICE

This unit has been designed to pump water only. This unit is not designed for applications involving salt water, brine or any other liquids including petroleum products. Use with salt, brine or any other liquids including petroleum products will void the warranty.

ELECTRICAL CONNECTION

For pumping systems using more than one pump, each pump needs to be connected to its own dedicated circuit protected by a fuse or breaker. The use of dedicated circuits will allow the other pumps to continue functioning even if the fuse or breaker of one of the pumps trips .



SAFETY INSTRUCTIONS :

This fine pump that you have just purchased is designed from the latest in material and workmanship.

Before installation and operation, we recommend the following procedures :

- A** Check with your local electrical and plumbing codes to ensure you comply with the regulations. These codes have been designed with your safety in mind. Be sure you comply with them.
- B** We recommend that the pump be used on a separate circuit lead from the home electrical distribution panel , and which is protected with a fuse or a circuit breaker. The motor must be securely plugged into a proper 'GFCI' electrical outlet. Consult a licensed electrician for all wiring.
- C** The ground terminal on the three prong plugs should never be removed. They are supplied and designed for your protection.
- D** Never make adjustments to any electrical appliance or product with the power connected. Do not only unscrew the fuse or trip the breaker, remove the power plug from the receptacle.

MONTHLY MANDATORY CHECK-UP :

1. Inspect the pump for any obvious condition that necessitates cleaning, correction, adjustment or repair.
2. Clear the surroundings of any paper, leaves or other debris that might clog the input openings. Remove anything that might float into the suction area.
3. Ensure that the pump is secure and vertical for proper operation.
4. Ensure that there is adequate clearance from any combustible materials or structure. Stored materials must be kept away from the pump. Shelves or cabinet structures must not be in close proximity to the pump.
5. Test the 'GFCI' outlet by pressing its test switch. This should prove that the outlet is energized and will trip off to protect against a ground fault. Be sure to reset the 'GFCI' by pressing its reset switch.
6. Put the necessary pail of water in the sump to prove that the pump will start when required and that any check valve present will permit effluent to flow.
7. Observe that the plumbing can carry the effluent safely out.

APPLICATION

- This submersible utility pump is designed for a portable application, for dewatering around homes.
- This pump is great for water transfer from basin, pool cover, flooded floor, flat roof.

FEATURES

- Non-corrosive material.
- Stainless steel mechanical rotary seal.
- Thermal and overload protection.
- 1/2HP, 115VAC, 60Hz, 4A, (8A when start).

CAPACITY

	<u>LPH</u>		<u>US GPH</u>
1.5m	15140	5'	4000
3.0m	11350	10'	3000
4.5m	10400	15'	2750
6.0m	8140	20'	2150
7.5m	6815	25'	1800

Friction loss
in pipe not
included.

NOTICE

This unit is not designed for applications to pump salt water or brine.
Use with salt water or brine will void warranty.

TYPICAL APPLICATIONS FOR THIS PRODUCT

STEP 1 Fix the enclosed pipe to the check valve.

STEP 2 Install the pump at the appropriate place to remove water.

STEP 3 Connect the plug to the electrical outlet. The pump will start when the water level reaches 2 1/2" (± 1/2").

STEP 4 Note that this electronic switch will continue to provide electricity to the pump for 30 seconds after the switch lever drops down, to allow the water to continue to drain through the pump's bottom suction feature.

STEP 5 Remove the plug from the electrical outlet to immediately stop.

Never run the pump dry

TO DRAIN POOL AND POOL COVER



TO DRAIN SPA



TO DRAIN FLOODED BASEMENT



REPAIR PARTS

REF.	PART	DESCRIPTION
1	311240	Power cable
2	311241	Cable holder
3	311242	Switch cable hook
4	311243	Cable holder screw
5	311244	Motor assembly
6	311245	Impeller
7	311246	Pump chamber housing
8	311247	Impeller washer
9	311248	Impeller nut
10	311249	Suction screen
11	311250	Suction screen screw
12	311251	Pump housing screw
Not shown		
13	150154	Support cable
14	300495	Discharge hose
15	350363	1 1/2" Check valve
16	450464	Electronic switch

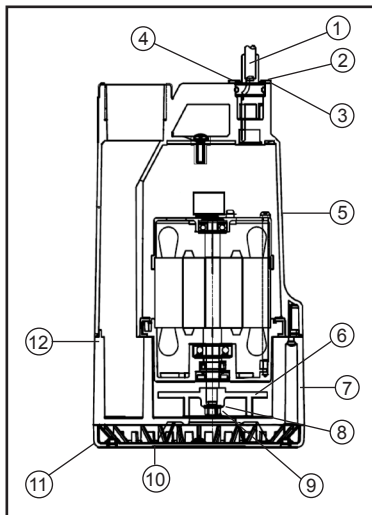

Repair parts may be ordered your authorized point of sale of from
BURCAM PUMPS

TROUBLE SHOOTING GUIDE CHECKLIST

NEVER MAKE ADJUSTMENTS TO ANY ELECTRICAL APPLIANCE OR PRODUCT WITH THE POWER CONNECTED. DON'T JUST UNSCREW THE FUSE OR TRIP THE BREAKER, REMOVE THE POWER FROM THE RECEPTACLE.

TROUBLE	PROBABLE CAUSE	ACTION
Motor does not run.	Blown fuse	Replace
	Tripped breaker	Reset
	Plug disconnected	Re-install
	Corroded plug	Clean prongs
	Low water level	Add water and verify
	Thermal overloaded	Unplug the pump for 15 minutes then restart.
	Defective motor	Replace/repair
Pump does not deliver to full capacity.	Jammed impeller	Clean
	Blocked suction/inlet	Check for debris in pit and clean
	Discharge leak	Repair
	Blocked line/pipe	Check for debris or ice
	Worn impeller	Repair/replace
	Defective motor	Replace/repair

TO THE END CONSUMER

*If you have any problems with the product, before advising the store, where you've purchased the pump, please contact us at **514 337-4415**, and ask for our sales department, and they will be pleased to help you with any questions you might have, concerning your installation.*