

# OPTIONAL VAC KIT

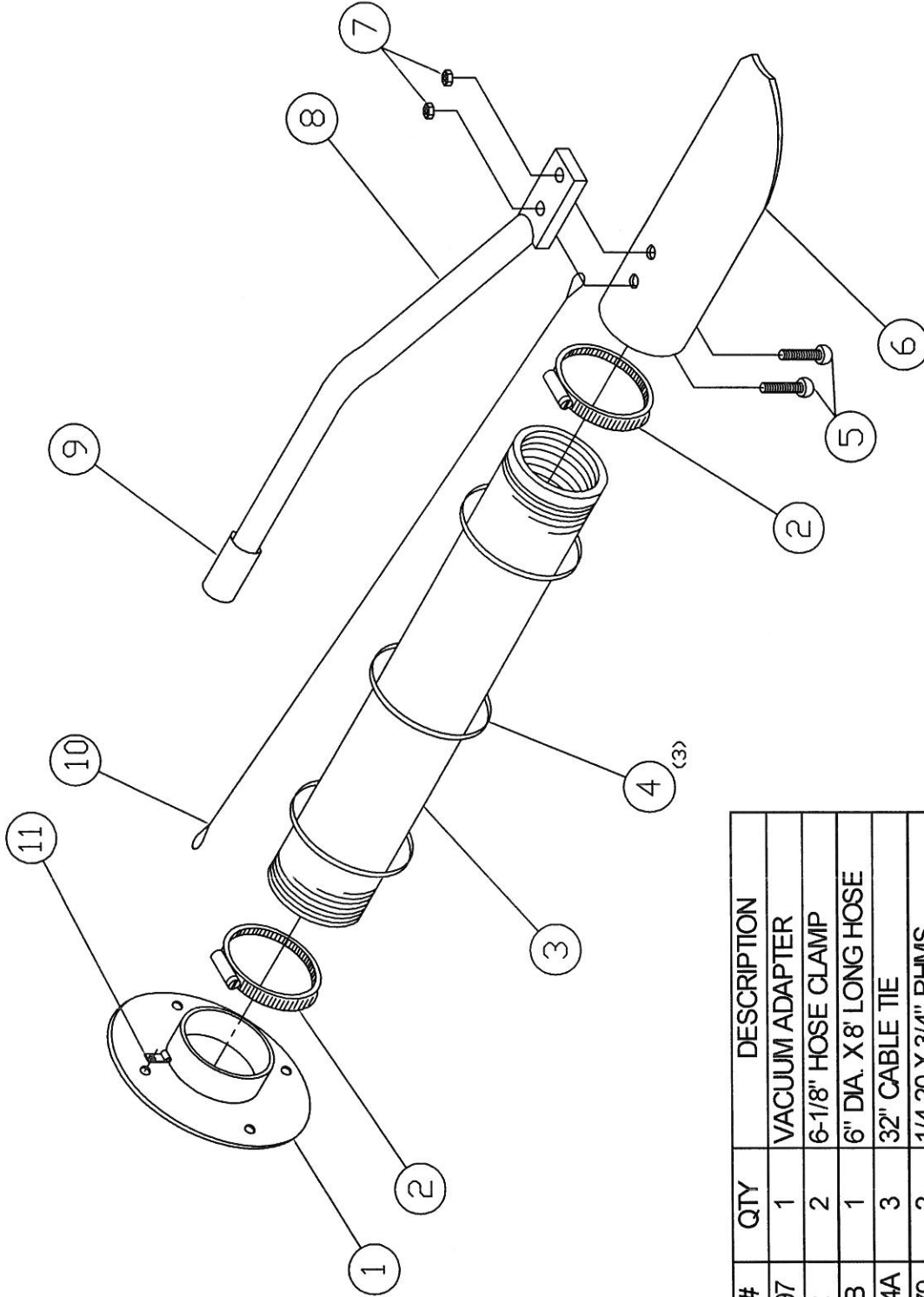

ITEM #	PART #	QTY	DESCRIPTION
1	805-0097	1	VACUUM ADAPTER
2	32412	2	6-1/8" HOSE CLAMP
3	32027-B	1	6" DIA X 8' LONG HOSE
4	900-0074A	3	32" CABLE TIE
5	090-0179	2	1/4-20 X 3/4" RHMS
6	704-0117	1	PICK-UP SNOOT
7	090-0470	2	1/4-20 NYLOCK NUT
8	804-0078	1	HANDLE
9	500-0041	1	HANDLE GRIP
10	704-0197	1	99' WIRE TETHER
11	706-2243	1	CABLE GUIDE

MacKISSIC, Inc., Parker Ford, PA	
VCB VAC KIT	
.015	SM
1/32	1/5
1"	07/01/03
	805-0129

## VACUUM-CHIPPER-BAGGER VACUUM KIT PART NO. 805-0129

**BE CERTAIN YOUR MACHINE IS TURNED OFF BEFORE INSTALLING KIT!**

**ASSEMBLY INSTRUCTIONS:**

1. Put one end of the wire tether (#9) onto the rear bolt between the handle (#8) and the pick-up snout (#6).
2. Attach the handle (#8) to the pick-up snout (#6) using the two locknuts (#7) and screws (#5) provided.
3. Connect the hose (#3) to the pick-up snout (#6) and vacuum adapter (#1) using the two hose clamps (#2).
4. Loop the loose end of the tether (#9) onto the cable guide (#10).
5. Secure the tether to the hose with the three cable ties (#4).

- NOTE:** The tether is intended to prevent the hose from pulling off the vac adapter.
6. Slip the handle grip onto the end of the handle.
  7. **BE SURE THE MACHINE IS TURNED OFF** before proceeding with installation. Remove the vac snout from the machine and attach the vacuum adapter with the same hardware.

**OPTIONAL VAC KIT**

ITEM #	PART #	QTY	DESCRIPTION
1	805-0097	1	VACUUM ADAPTER
2	32412	2	6-1/8" HOSE CLAMP
3	32027-B	1	6" DIA. X 8' LONG HOSE
4	900-0074A	3	32" CABLE TIE
5	090-0179	2	1/4-20 X 3/4" RHMS
6	704-0117	1	PICK-UP SNOOT
7	090-0470	2	1/4-20 NYLOCK NUT
8	804-0078	1	HANDLE
9	500-0041	1	HANDLE GRIP
10	704-0197	1	99" WIRE TETHER
11	706-2243	1	CABLE GUIDE

MacKISSIC, Inc. Parker Ford, PA	
.015	VCB VAC KIT
1/32	SM 1/5
1"	C 07/01/03

805-0129