

FRONT, REAR AND SIDE ADVANCED WIND BAFFLE WB-PA/WB-SD/WB-RE



Job Name:

System Reference:

Date:

APPLICATION

- The Wind Baffles are used to extend the cooling temperature operation range of the PUY, PUZ, MXZ and PUMY models
- The information below outlines which wind baffles to utilize per required operation range
- Please refer to the installation manual of the appropriate outdoor unit for correct installation requirements



COOLING TEMPERATURE OPERATION RANGE WITH WIND BAFFLES

Model Series	Operation Range Without Wind Baffles	Front Wind Baffles	Front + Advanced Side + Advanced Rear Wind Baffles
PUZ-7	23° F - 115° F	0° F	N/A
PUY-7	23° F - 115° F	0° F	-40° F
PUMY*	23° F - 115° F	5° F	N/A
MXZ	23° F - 115° F	5° F	N/A

*Operation range varies based on indoor unit connected, refer to service manual for applicable indoor units

**If unit is exposed without wall surfaces surrounding for protection from wind, then side and rear wind baffles will be required. Please refer to installation dimensions and outdoor unit installation manual for appropriate requirements.

Models	Type and Quantity								
	Front Wind Baffles			Advanced Side Wind Baffles			Advanced Rear Wind Baffles		
	WB-PA3	WB-PA4	WB-PA5	WB-SD4	WB-SD5	WB-SD6	WB-RE4	WB-RE5	WB-RE6
PUY-A12NKA7		1		1			1		
PUY-A18NKA7		1		1			1		
PUY-A24NHA7			1		1			1	
PUY-A30NHA7			1		1			1	
PUY-A36NKA7	2					1			1
PUY-A42NKA7	2					1			1
PUZ-A12NKA7		1							
PUZ-A18NKA7		1							
PUZ-A24NHA7			1						
PUZ-HA24NHA			1						
PUZ-HA30NHA5			2						
PUZ-HA36NHA5			2						
PUZ-HA42NKA	2								
PUZ-A30NHA7			1						
PUZ-A36NKA7	2								
PUZ-A42NKA7	2								
MXZ-8C48NA	2								
MXZ-8C60NA	2								
MXZ-4C36NAHZ	2								
MXZ-5C42NAHZ	2								
MXZ-8C48NAHZ	2								
PUMY-P36NKMU2	2								
PUMY-P48NKMU2	2								
PUMY-P60NKMU2	2								
PUMY-HP36NKMU	2								
PUMY-HP48NKMU	2								

FRONT, REAR AND SIDE ADVANCED WIND BAFFLE WB-PA/WB-SD/WB-RE

FRONT WIND BAFFLE WB-PA3 / WB-PA4 / WB-PA5

GENERAL FEATURES

- Front Wind Baffles allow outdoor units to operate at full capacity down to the temperature ranges shown in the table above.
- Prevents wind from reversing outdoor fan rotation when unenergized .
- Durable and low maintenance construction.

PLEASE NOTE

- Install outdoor units with the back surface facing wall side to eliminate the effects of external wind
- Outdoor units should not be installed in an orientation or site where the wind blows directly at the back of the unit
- Wind baffle should not be used where there is any obstacle at either side or above the outdoor unit as the discharged air will be blocked
- Refer to outdoor unit for detailed installation instructions

WB-PA3



WB-PA4 / WB-PA5



FRONT, REAR AND SIDE ADVANCED WIND BAFFLE WB-PA/WB-SD/WB-RE

ADVANCED WIND BAFFLE WB-SD / WB-RE

GENERAL FEATURES

- Advanced Side and Rear Wind Baffles allow outdoor units to operate at full capacity down to the temperature ranges shown in the table above
- Prevents wind from reversing outdoor fan rotation when unenergized
- Durable and low maintenance construction

PLEASE NOTE

- Installation location will dictate Advanced wind baffle requirements
- Refer to the installation manual for additional details
- Advanced Wind Baffles should be installed to prevent any wind blowing directly into the unit
- Front Wind Baffle (WB-PA3, WB-PA4, WB-PA5) is also required for -40° F operation of PUY models

WB-SD4



WB-SD5



WB-SD6



WB-RE4



WB-RE5



WB-RE6



WIND BAFFLE SPECIFICATIONS

Models	Exterior			Weight
	Color	Surface Treatment	Material	
WB-PA3	Matches P-Series Outdoor Unit (Ivory Munsell 3Y 7.8/1.1)	Polyester Powder Coating	Alloy Hot-Dip Zinc Coated Carbon Steel Sheet	8 Lbs. 8 Oz.
WB-PA4				7 Lbs. 7.9 Oz.
WB-PA5				8 Lbs. 8 Oz.
WB-SD4				6 Lbs.
WB-SD5				10 Lbs.
WB-SD6				15 Lbs.
WB-RE4				11 Lbs.
WB-RE5				18 Lbs.
WB-RE6				35 Lbs.

FRONT, REAR AND SIDE ADVANCED WIND BAFFLE WB-PA/WB-SD/WB-RE

DIMENSIONS

WB-PA3

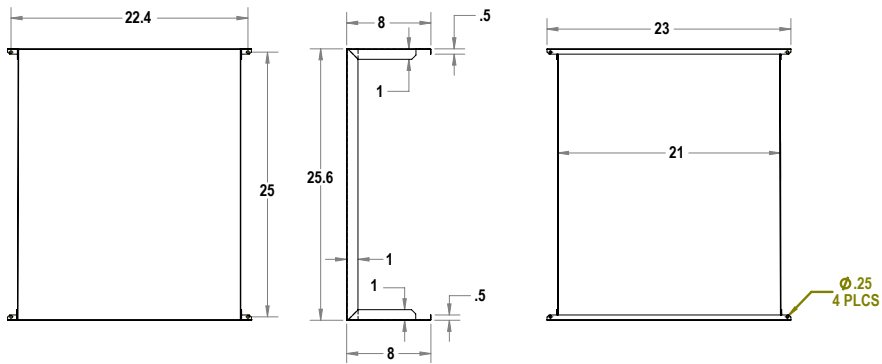
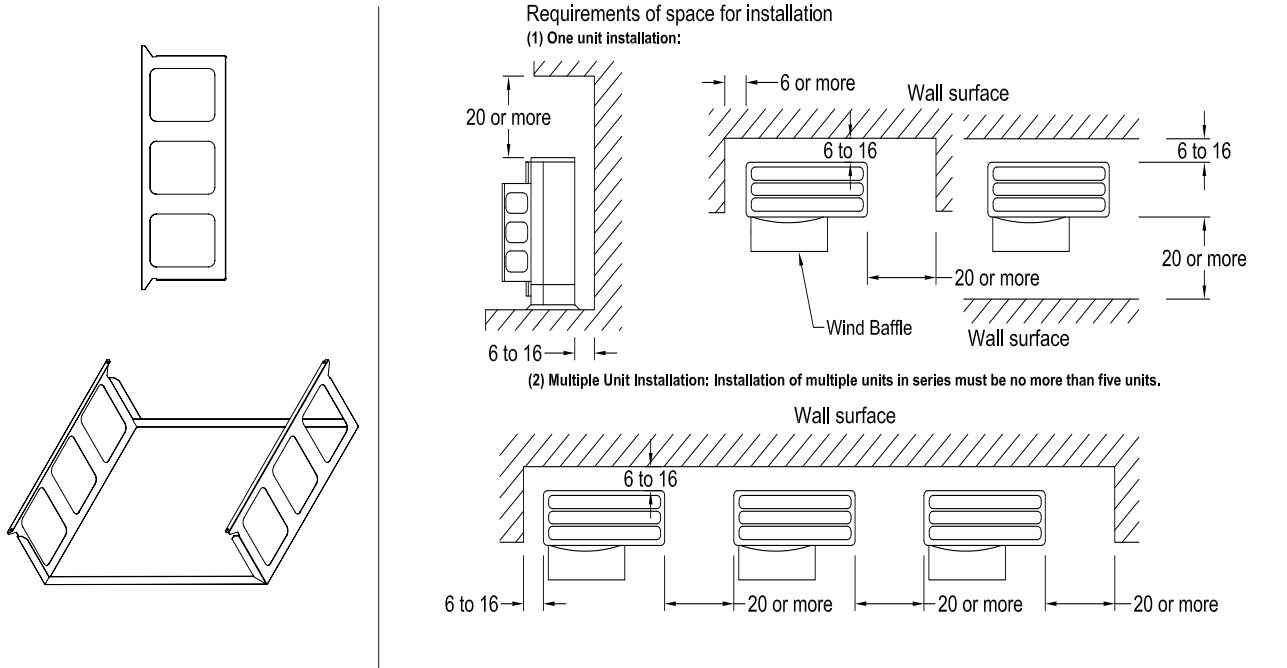

ALL DIMENSIONS IN INCHES
ALL DIMENSION $\pm \frac{1}{32}$ "

FRONT, REAR AND SIDE ADVANCED WIND BAFFLE WB-PA/WB-SD/WB-RE

DIMENSIONS

WB-PA4

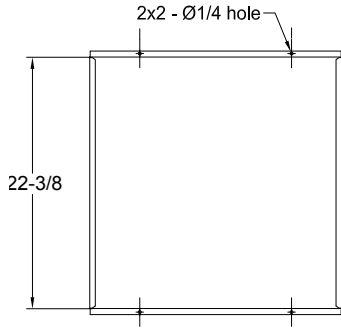

Back View

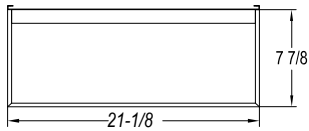

Side View

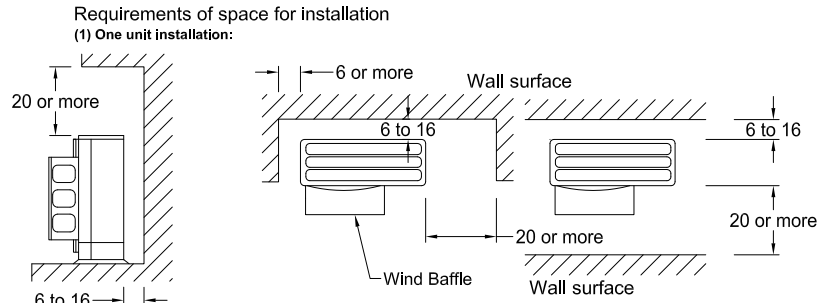

(2) Multiple Unit Installation: Installation of multiple units in series must be no more than five units.

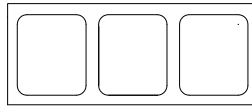
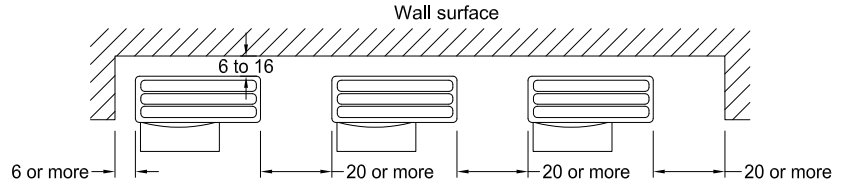

Top View

ALL DIMENSIONS IN INCHES
ALL DIMENSIONS $\pm \frac{1}{32}$ "

FRONT, REAR AND SIDE ADVANCED WIND BAFFLE WB-PA/WB-SD/WB-RE

DIMENSIONS

WB-PA5

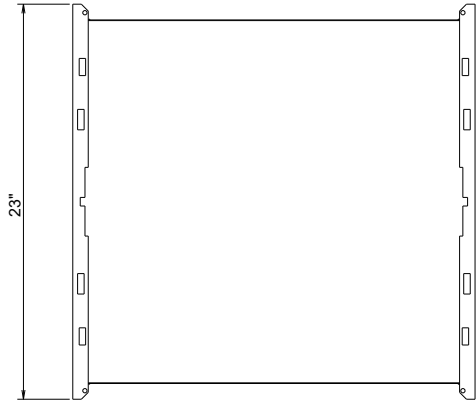

Requirements of space for installation

(1) One unit installation:

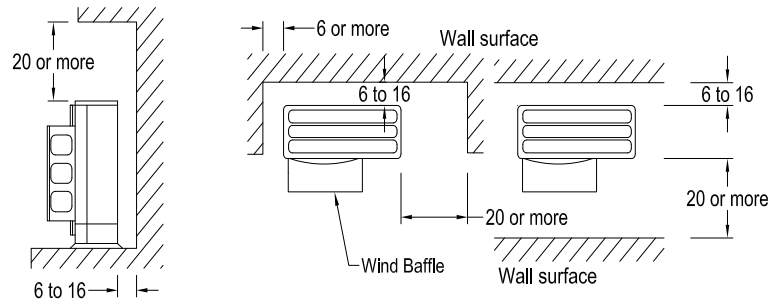

(2) Multiple Unit Installation: Installation of multiple units in series must be no more than five units.

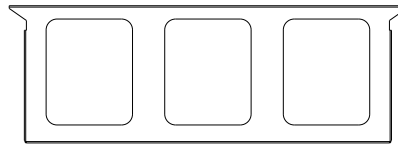
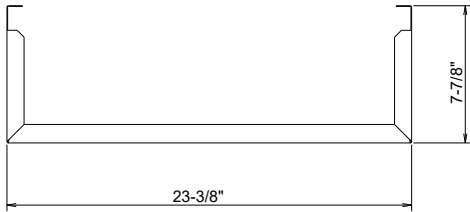
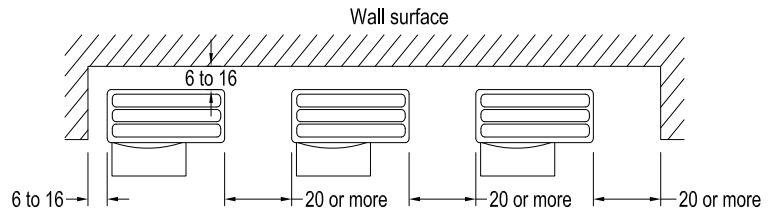

ALL DIMENSIONS IN INCHES
ALL DIMENSION $\pm \frac{1}{32}$ "

FRONT, REAR AND SIDE ADVANCED WIND BAFFLE WB-PA/WB-SD/WB-RE

DIMENSIONS

WB-SD4

Unit: inch

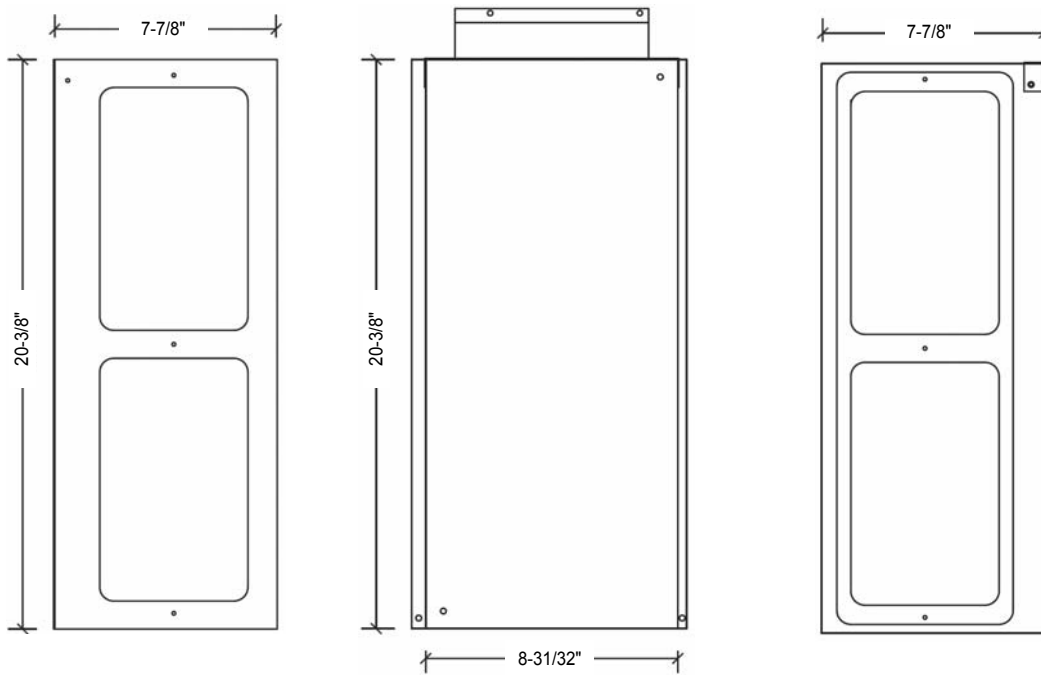

WB-RE4

Unit: inch

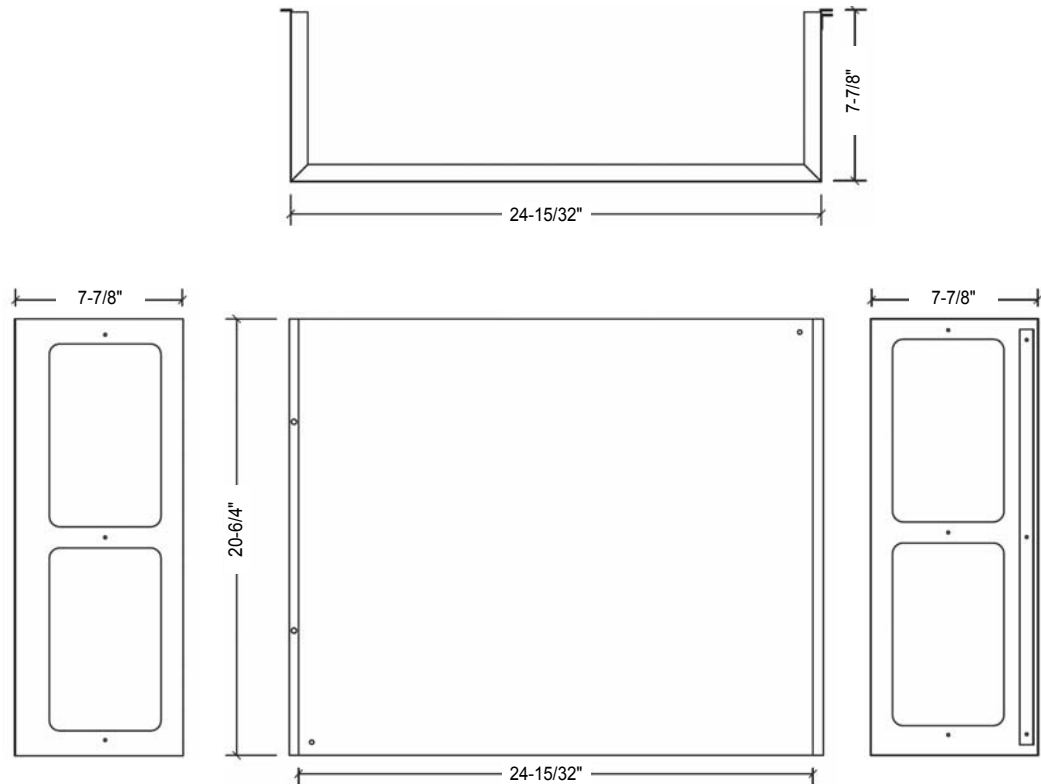

FRONT, REAR AND SIDE ADVANCED WIND BAFFLE WB-PA/WB-SD/WB-RE

DIMENSIONS

WB-SD5

Unit: inch

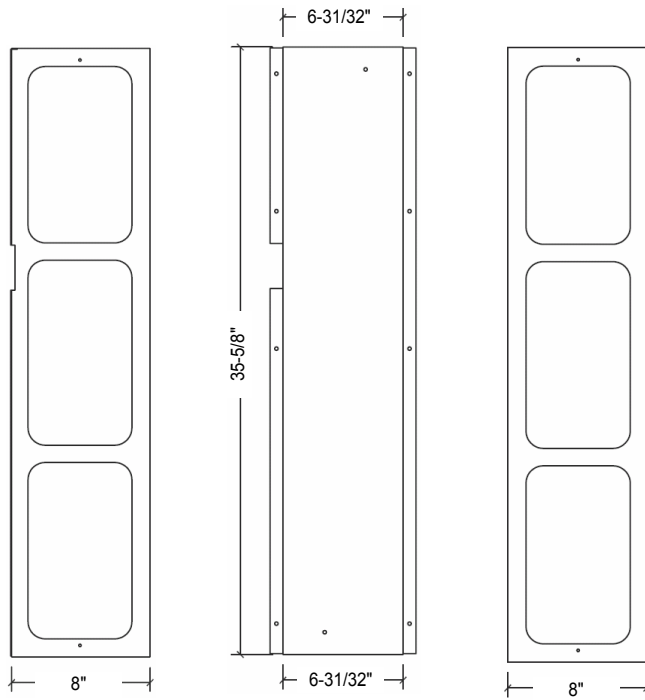

WB-RE5

Unit: inch

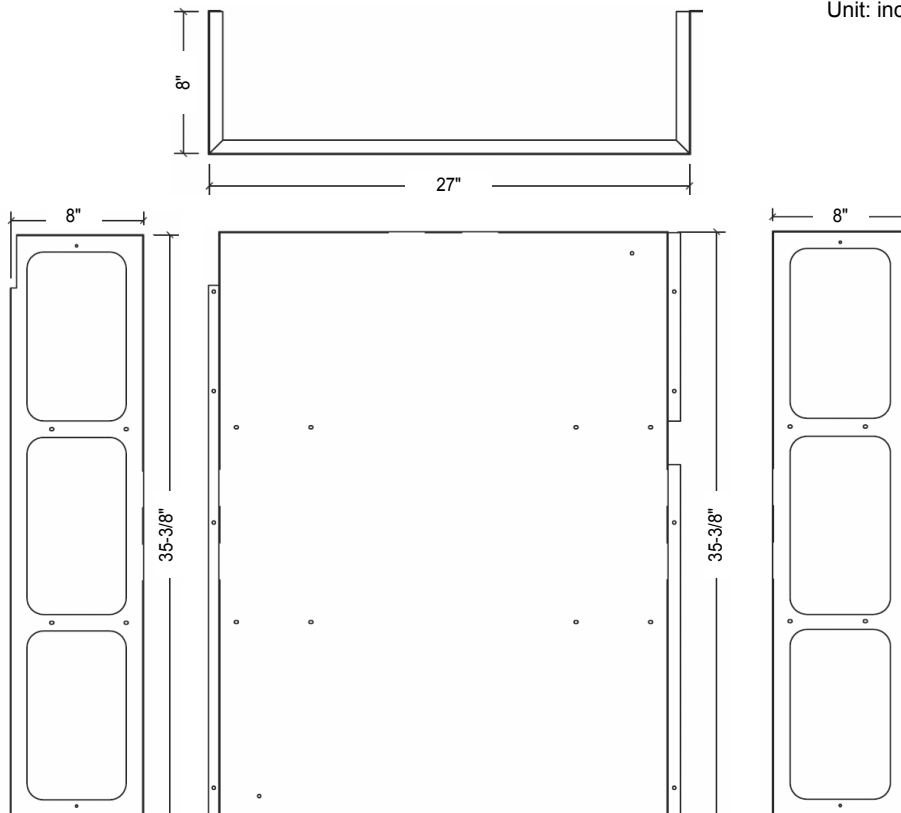

FRONT, REAR AND SIDE ADVANCED WIND BAFFLE WB-PA/WB-SD/WB-RE

DIMENSIONS

WB-SD6

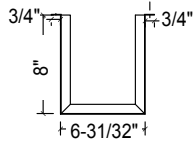

Unit: inch

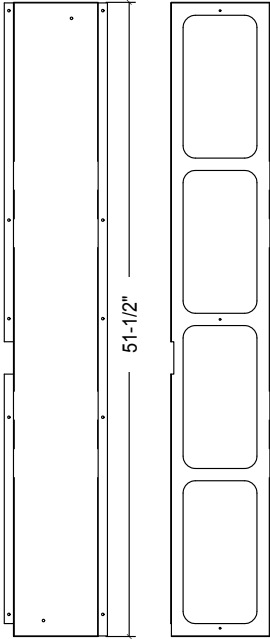

WB-RE6

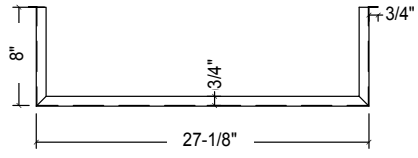

Unit: inch

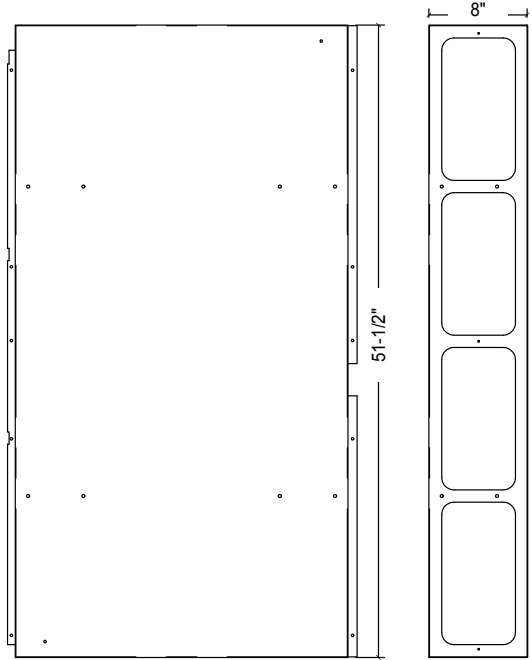

FRONT, REAR AND SIDE ADVANCED WIND BAFFLE WB-PA/WB-SD/WB-RE

APPENDIX - PREVIOUS GENERATION COMPATIBILITY

Models	Front Wind Baffles				Advanced Side Wind Baffles			Advanced Rear Wind Baffles		
	WB-PA1	WB-PA2 ⁽¹⁾	WB-PA3	WB-PA5	WB-SD1	WB-SD2 ⁽²⁾	WB-SD3	WB-RE1	WB-RE2 ⁽³⁾	WB-RE3
PUY/Z-A-A12NHA4	1									
PUY/Z-A-A18NHA4	1									
PUY/Z-A-A24NHA4		1								
PUY/Z-A-A30NHA4		1								
PUY/Z-A-A36NHA4		1								
PUY/Z-A-A42NHA4		2								
PUY/Z-A-A42NHA5		2								
PUZ-HA30NHA4		2								
PUZ-HA36NHA4		2								
PUMY-P36NHMU				2						
PUMY-P36NKMU1			2							
PUMY-P48NHMU				2						
PUMY-P48NKMU1			2							
PUMY-P60NKMU/1			2							
PUY/Z-A12NHA6	1				1			1		
PUY/Z-A18NHA6	1				1			1		
PUY/Z-A24NHA6		1				1			1	
PUY/Z-A30NHA6		1				1			1	
PUY/Z-A36NHA6		1				1			1	
PUY/Z-A42NHA6		2					1			1

⁽¹⁾ WB-PA2 is replaced by WB-PA5

⁽²⁾ WB-SD2 is replaced by WB-SD5

⁽³⁾ WB-RE2 is replaced by WB-RE5

COOLING TEMPERATURE OPERATION RANGE WITH WIND BAFFLES

Model Series	Operation Range Without Wind Baffles	Front Wind Baffles Only	Front + Advanced Side + Advanced Rear Wind Baffles
PUZ-4	23°F - 115°F	0°F	N/A
PUY-4	23°F - 115°F	0°F	N/A
PUZ-5	23°F - 115°F	0°F	N/A
PUY-5	23°F - 115°F	0°F	N/A
PUZ-6	23°F - 115°F	0°F	N/A
PUY-6*	23°F - 115°F	0°F	-20°F

*PUY-A42NHA6 units do not have the extended cooling range below 0° F

1340 Satellite Boulevard, Suwanee, GA 30024
Toll Free: 800-433-4822 www.mehvac.com